

# TIMEX®

Register your product  
at [www.timex.com](http://www.timex.com)

W-225 314-095000 NA



## **THANK YOU FOR PURCHASING YOUR TIMEX® WATCH.**

### **EXTENDED WARRANTY**

**Available in U.S. only.** Extend your warranty for an additional 4 years from date of purchase for \$5. You can pay with AMEX, Discover, Visa or MasterCard by calling 1 800-448-4639 during normal business hours. Payment must be made within 30 days of purchase. Name, address, telephone number, purchase date, and 5-digit model number required. You can also mail a check for \$5 to: Timex Extended Warranty, P.O. Box 1676, Dept. EF, Little Rock, AR 72203.

Please read instructions carefully to understand how to operate your Timex® watch. **Your model may not have all of the features described in this booklet.**

### **OVERVIEW**

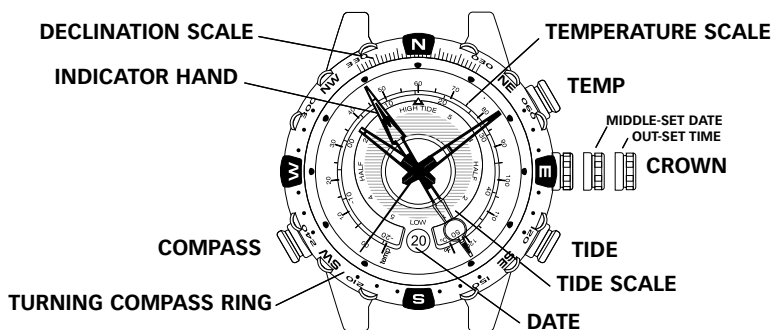

NOTE: Watch is shipped with guard around crown. Remove guard and push crown in to start. **Compass must be calibrated before using to ensure accuracy and avoid improper headings.** See COMPASS CALIBRATION. Go to [www.timex.com/expedition](http://www.timex.com/expedition) for help.

Watch incorporates magnetic sensor technology of Precision Navigation Inc., Mountain View, CA.

### **SET DATE AND TIME**

Pull crown to MIDDLE position and turn until correct date appears. After setting date, pull crown all the way out and turn until correct time is shown. Ensure correct AM/PM setting by verifying that date changes at midnight, not noon. Push crown in when done. Adjust date after months with fewer than 31 days.

### **INDICATOR HAND ADJUSTMENT**

Pull crown all the way out. Indicator hand should point to 12 o'clock. If it does not, press either TIDE or TEMP push button to move hand until it points to 12 o'clock. TIDE and TEMP push buttons move hand clockwise and counterclockwise, respectively. Hold push button to move hand fast. Push crown in when done.

### **TIDE/TEMPERATURE SELECTION**

Indicator hand shows either tide or temperature constantly. When temperature is shown, press TIDE push button to select tide clock. Hand moves to low tide and then to current tide. When tide is shown, press TEMP push button to select thermometer. Hand moves to beginning of thermometer scale and then to current temperature.

### **TIDE CLOCK**

For tide clock, indicator hand always rotates clockwise, so tide is rising when hand is pointing left and falling when pointing right. Number of hours to next high/low tide is shown on tide scale.

The primary factor in determining tides is moon position. Tide clock uses moon position to predict high and low tides, which are 6 hours and 12.5 minutes apart.

Tides are also influenced by sun position and shape of shoreline, so tide clock cannot precisely give times of high and low tides. Periodic adjustment may be necessary.

To set tide clock, pull crown to MIDDLE position. Press either TIDE or TEMP push button to move hand to current tide. TIDE and TEMP push buttons move hand clockwise and counterclockwise, respectively. Push crown in when done.

For tide information, go to [www.timex.com/expedition](http://www.timex.com/expedition)

### **THERMOMETER**

When worn on wrist, thermometer reading is affected by body heat. For more accurate readings, remove watch and put in shade for at least several minutes.

Watch can measure water temperature also, if submerged. Be sure to select temperature display before placing watch in water, as buttons should not be pressed when watch is underwater.

Thermometer readings are taken every minute, and more frequently, if temperature is changing.

### **COMPASS CALIBRATION**

Since a compass uses the earth's magnetic field, you must be aware of large metallic objects, such as vehicles or bridges, or objects that give off electromagnetic radiation, such as TVs or PCs, which could affect the magnetic field around the watch. If compass is calibrated near such objects, it will only work properly in that same location. If compass is calibrated away from such objects, it will not work properly near them.

**For best results, calibrate in area of intended use.**

In calibrating and taking headings, it is important, as with all compasses, to keep compass level. Calibrating or taking a heading when watch is not level can result in large errors. Also avoid areas that may exhibit higher than normal concentrations of hard and soft iron, as they may cause inaccurate headings. Whenever a heading is suspect, recalibrate.

Do not store watch near any source of magnetism, such as computers, appliances, or TVs, as watch can take on a magnetic charge, yielding inaccurate headings.

To calibrate compass, pull crown to MIDDLE position. Keep watch level or place on level surface (if band interferes, place watch on inverted cup). Watch may be face down, but take care to protect watch face. Press COMPASS push button to begin. Indicator hand rotates two revolutions to remind you to rotate watch. While level, **SLOWLY** rotate watch two revolutions, **taking at least 15 seconds per revolution. This is critical in achieving proper calibration.**

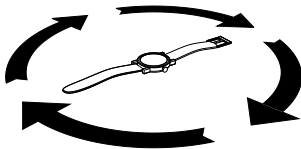

When done, press any push button, keeping watch level. Indicator hand moves back and forth to acknowledge end of calibration and then moves to current declination angle setting (see DECLINATION ANGLE for more information). If you do not wish to set declination angle, push crown in. Otherwise, to have watch automatically compensate for declination angle, turn compass ring until north is at 12 o'clock. Press either TIDE or TEMP push button to move indicator hand east (+) or west (-) to point to your location's declination angle (see table below) using declination scale. Hold push button to move hand fast. Push crown in when done.

### **COMPASS OPERATION**

Normally, compass is off and indicator hand shows tide or temperature.

Compass must be calibrated prior to use and calibration should be performed in the area of intended use; see COMPASS CALIBRATION. If compass has not been calibrated since battery replacement, attempting to activate compass causes watch to rotate indicator hand once and play melody to remind you to calibrate.

While holding watch level, press COMPASS push button to activate compass. Indicator hand moves to point north. If watch is turned, indicator hand will continue to move, always pointing north. After 20 seconds, compass will automatically turn off and hand will return to its normal operation. This conserves battery life. Press COMPASS push button at any time to keep compass on for another 20 seconds.

NOTE: While compass is on, INDIGLO® night-light may flicker slightly when on. This is normal, as night-light must be turned off briefly during compass readings to maintain accuracy. Also, second hand moves in two-second increments while compass is on.

## USING THE COMPASS

Once compass is activated, as described above, there are two typical ways to use it.

**Which way am I headed?** Hold watch so that 12 o'clock is in direction of your travel. Turn compass ring until indicator hand is pointing to north on ring. Your heading is direction on ring at 12 o'clock.

**Which way should I go?** If you know the direction you want to go (e.g., NE), turn compass ring until that direction appears at 12 o'clock. Hold watch so that you are facing 12 o'clock. Then, turn your body until indicator hand points to north on compass ring. You are now facing the direction you want to go.

## DECLINATION ANGLE

A compass needle points to "magnetic north," which may be slightly different from "true north," which is used on maps. This difference, called the "declination angle," which varies around the globe, is typically small and can be ignored in many cases. However, if you wish to compensate for this difference, there are two ways to do so. You can do it manually by turning the compass ring so that indicator hand points to your declination angle (see table below) instead of north, using declination scale on compass ring. Or, you may have the watch automatically compensate by setting your declination angle after compass calibration; see COMPASS CALIBRATION. With proper declination angle set, indicator hand will point to true north.

Declination angles for major world cities (W is negative and E is positive on declination scale).

Anchorage . . . . .20E	London . . . . .2W	Rio De Janeiro . . . . .22W
Atlanta . . . . .4W	Little Rock . . . . .1E	San Francisco . . . . .15E
Bombay . . . . .1W	Livingston, MT . . . . .13E	Seattle . . . . .18E
Boston . . . . .15W	Munich . . . . .2E	Shanghai . . . . .5W
Calgary . . . . .16E	New York City . . . . .13W	Toronto . . . . .11W
Chicago . . . . .3W	Orlando . . . . .5W	Vancouver . . . . .18E
Denver . . . . .9E	Oslo . . . . .1E	Washington DC . . . . .11W
Jerusalem . . . . .4E	Paris . . . . .1W	Waterbury, CT . . . . .14W

For more magnetic declination information go to [www.timex.com/expedition](http://www.timex.com/expedition)

## INDIGLO® NIGHT-LIGHT

Press crown to illuminate watch face. Electroluminescent technology used in the INDIGLO® night-light illuminates entire watch face at night and in low light conditions.

## BRACELET ADJUSTMENT

### FOLDOVER CLASP BRACELET

Find spring bar that connects bracelet to clasp. Using a pointed tool (Fig. 1), push spring bar in and gently twist bracelet to disengage. Determine wrist size, then insert spring bar in correct bottom hole (Fig. 2). Push down on spring bar, align with top hole and release to lock in place (Fig. 3).

### BRACELET LINK REMOVAL

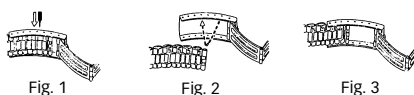

**Removing Links:** Place bracelet upright and insert pointed tool in opening of link. Push pin forcefully in direction of arrow until link is detached (pins are designed to be difficult to remove). Repeat until desired number of links are removed.

**Reassembly:** Rejoin bracelet parts. Push pin back into link in opposite direction of arrow. Press pin down securely into bracelet until it is flush.

### SOLID LINK BRACELET

**Removing Links:** Using a very small screwdriver, remove screws by turning counterclockwise. Repeat until desired number of links are removed. Do not remove links adjacent to clasp.

**Reassembly:** Rejoin bracelet parts and insert screw in end of opening where it was removed. Turn screw clockwise until tight and flush with bracelet.

### BARREL LINK BRACELET WITH SCREW HEAD PINS

**Removing Links:** Removable links have arrows. Use one screwdriver near tail of arrow to prevent pin from turning. Using another screwdriver, remove screw at end near head of arrow by turning it counterclockwise. After removing screw, slide pin out. Repeat for second pin in link.

**Reassembly:** Rejoin bracelet parts and insert pin in end of opening where it was removed. Turn screw and other end clockwise until tight and flush with bracelet.

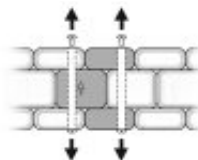
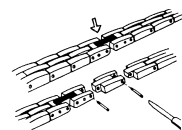
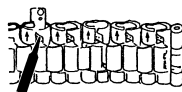

## WATER RESISTANCE

If your watch is water-resistant, meter marking or ( ) is indicated.

Water-Resistance Depth	p.s.i.a. * Water Pressure Below Surface
<b>30m/98ft</b>	<b>60</b>
<b>50m/164ft</b>	<b>86</b>
<b>100m/328ft</b>	<b>160</b>

\*pounds per square inch absolute

### WARNING: TO MAINTAIN WATER-RESISTANCE, DO NOT PRESS ANY BUTTONS UNDER WATER.

1. Watch is water-resistant only as long as lens, push buttons and case remain intact.
2. Watch is not a diver watch and should not be used for diving.
3. Rinse watch with fresh water after exposure to salt water.

## BATTERY

**Timex strongly recommends that a retailer or jeweler replace battery.** Battery type is on watch back. If present, push/short internal reset switch after replacing battery. Battery life estimates are based on certain assumptions regarding usage; battery life may vary depending on actual usage.

**DO NOT DISPOSE OF BATTERY IN FIRE. DO NOT RECHARGE. KEEP LOOSE BATTERIES AWAY FROM CHILDREN.**

### TIMEX INTERNATIONAL WARRANTY

(U.S. – LIMITED WARRANTY – PLEASE SEE FRONT OF INSTRUCTION BOOKLET  
FOR TERMS OF EXTENDED WARRANTY OFFER)

Your TIMEX® watch is warranted against manufacturing defects by Timex Corporation for a period of ONE YEAR from the original purchase date. Timex and its worldwide affiliates will honor this International Warranty.

Please note that Timex may, at its option, repair your watch by installing new or thoroughly reconditioned and inspected components or replace it with an identical or similar model. **IMPORTANT — PLEASE NOTE THAT THIS WARRANTY DOES NOT COVER DEFECTS OR DAMAGES TO YOUR WATCH:**

- 1) after the warranty period expires;
- 2) if the watch was not originally purchased from an authorized Timex retailer;
- 3) from repair services not performed by Timex;
- 4) from accidents, tampering or abuse; and
- 5) lens or crystal, strap or band, watch case, attachments or battery. Timex may charge you for replacing any of these parts.

THIS WARRANTY AND THE REMEDIES CONTAINED HEREIN ARE EXCLUSIVE AND IN LIEU OF ALL OTHER WARRANTIES, EXPRESS OR IMPLIED, INCLUDING ANY IMPLIED WARRANTY OF MERCHANTABILITY OR FITNESS FOR PARTICULAR PURPOSE. TIMEX IS NOT LIABLE FOR ANY SPECIAL, INCIDENTAL OR CONSEQUENTIAL DAMAGES. Some countries and states do not allow limitations on implied warranties and do not allow exclusions or limitations on damages, so these limitations may not apply to you. This warranty gives you specific legal rights and you may also have other rights which vary from country to country and state to state.

To obtain warranty service, please return your watch to Timex, one of its affiliates or the Timex retailer where the watch was purchased, together with a completed original Watch Repair Coupon or, in the U.S. and Canada only, the completed original Watch Repair Coupon or a written statement identifying your name, address, telephone number and date and place of purchase. Please include the following with your watch to cover postage and handling (this is not a repair charge): a US\$ 7.00 check or money order in the U.S.; a CAN\$6.00 cheque or money order in Canada; and a UKE2.50 cheque or money order in the U.K. In other countries, Timex will charge you for postage and handling. NEVER INCLUDE A SPECIAL WATCH-BAND OR ANY OTHER ARTICLE OF PERSONAL VALUE IN YOUR SHIPMENT.

For the U.S., please call 1-800-448-4639 for additional warranty information. For Canada, call 1-800-263-0981. For Brazil, call +55 (11) 5572 9733. For Mexico, call 01-800-01-060-00. For Central America, the Caribbean, Bermuda and the Bahamas, call (501) 370-5775 (U.S.). For Asia, call 852-2815-0091. For the U.K., call 44 020 8687 9620. For Portugal, call 351 212 946 017. For France, call 33 3 81 63 42 00. For Germany, call 49 7 231 494140. For the Middle East and Africa, call 971-4-310850. For other areas, please contact your local Timex retailer or Timex distributor for warranty information. In Canada, the U.S. and in certain other locations, participating Timex retailers can provide you with a postage-paid, pre-addressed Watch Repair Mailer for your convenience in obtaining factory service.

©2005 Timex Corporation. TIMEX is a registered trademark of Timex Corporation. INDIGLO is a registered trademark of Indiglo Corporation in the U.S. and other countries.