

20007015120

Blade riser, fixed head and handset

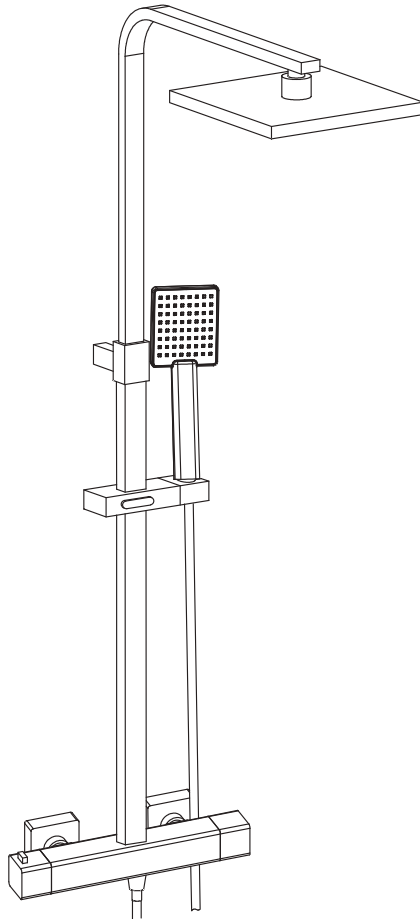

INSTALLATION INSTRUCTIONS





This product should only be fitted by a qualified plumber. Should the installation be completed by a non-qualified person then the guarantee may be considered invalid.

For a claim made under our warranty written certification of your installers credentials will be required.

INSTRUCTION

Safety Warning

Bathstore thermostatic mixers are precision engineered and should give continued safe and controlled performance, provided:

- 1.They are installed, commissioned, operated and maintained in accordance with the manufacturer's recommendations.
- 2.Periodic attention is given, when necessary, to maintain the product in good functional order.

Caution!

- 1.Read all of these instructions.
- 2..Retain this guide for later use.
- 3.Pass on this guide in the event of change of ownership of the installation site.
- 4.Follow all warnings, cautions and instructions contained in this guide.
- 5.Anyone who may have difficulty understanding or operating the controls of any shower should be accompanied while showering. Particular consideration should be given to the young, the elderly, the infirm or anyone inexperienced in the correct operation of the controls.
- 6.Rapid/Excessive movement of the flow and/or temperature control handles may result in momentary unstable blend temperatures.
- 7.Care is required when adjusting flow or temperature, make sure that the temperature has stabilised.
- 8.When this product has reached the end of its serviceable life, it should be disposed of in a safe manner, in accordance with current local authority recycling, or waste disposal policy.

PACK CONTENTS

Tick the appropriate boxes to familiarise yourself with the part names and to confirm that all of the parts are included.

☐ 1 X Wall Plug

☐ 1 X Fixing Screw

☐ 1 X Securing Bracket

☐ 1 X Rigid Riser

☐ 1 X Deluge Head & Seal

☐ 1 X Showerhead

☐ 1 X Showerhead Holder

☐ 1 X PVC Shower Hose
& 2 X Seal Washer

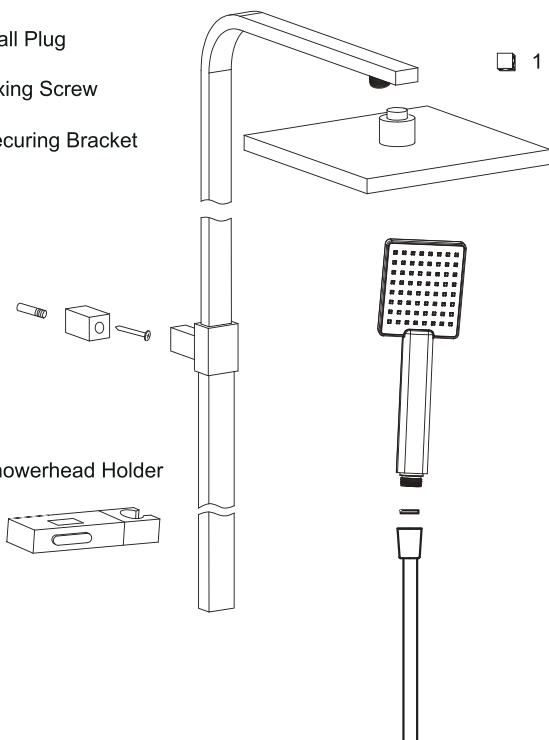

DIMENSIONS

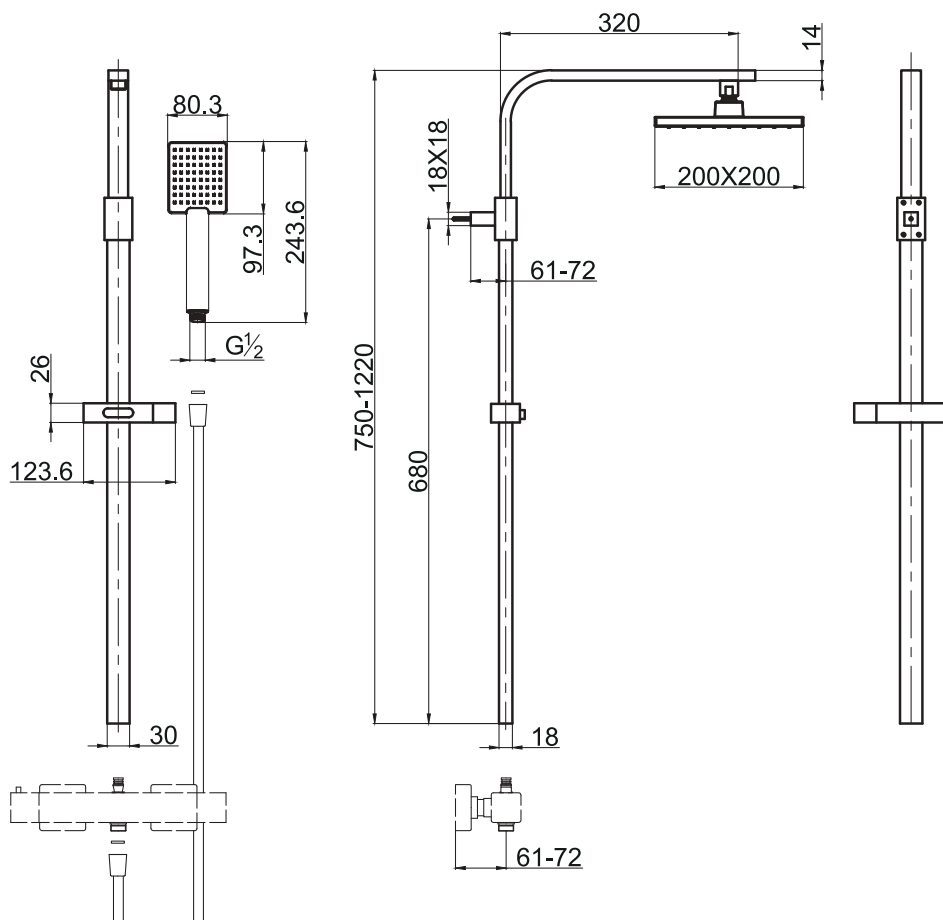

NOTE: ALL DIMENSIONS IN MILLMETRES

CLEANING

The chrome plated parts should be cleaned using a mild washing up detergent or soap solution, rinsed and then wiped dry with a soft cloth.

Warning! Many household cleaners contain abrasive and chemical substances, and should NOT be used for cleaning plated or plastic fittings. Do NOT use descalents on this product.

FILTERS

The sealing washers / filters are located in the inlet connector. Clean or renew as necessary.

LUBRICANTS

Only silicone based lubricants must be used on the rubber seals.

Caution! Oil based or other lubricant types may cause rapid deterioration of seals.

INSTALLATION

Suitable Plumbing Systems

Gas Heated System:

The thermostatic mixer can be installed with a combination boiler.

Unvented Mains Pressure System:

The thermostatic mixer can be installed with an unvented, stored hot water system.

Mains Pressurised Instantaneous Hot Water System:

The thermostatic mixer can be installed with systems of this type with balanced pressures.

Pumped System:

The thermostatic mixer can be installed with an inlet pump (twin impeller).

The pump should be installed on the floor next to the hot cylinder.

General

Installation must be carried out in accordance with these instructions, and must be conducted by designated, qualified and competent personnel. The installation must comply with the relevant water supply regulations or any particular regulations and practices, specified by local water company.

Note! Make sure all site requirements correspond to the information given in section '**Specification**'.

1. The mixer must not be installed in an area where it may freeze.
2. For stud partitions, alternative fixings may be required.
3. Isolation valves must be installed close to the mixer for ease of maintenance.
4. Pipeworks must be rigidly supported to avoid any strain on the connections.
5. Pipework dead-legs should be kept to a minimum.
6. All pipework must be checked for leaks before the product installation is completed.
The product should be pressurised & the inlet & outlet connections inspected.
7. Do not overtighten the grub screws as the product damage may occur. Use the hexagonal key provided and hand tighten only. Do NOT use power tools.

INSTALLATION

1. Pressing the button, slide the showerhead holder over the rigid riser, In suitable position, release the button to secure the holder
2. Locate the rigid riser rail into the valve outlet and the securing bracket cover into the securing bracket, making sure that they are pushed fully home. Then screw the grub screws to secure.

Important! Using a spirit level make sure that the rigid riser rail is vertical and mark the position of the fixing holes for the securing bracket on the wall.

Caution! Do not cut the rigid riser rail.

3. For solid walls drill the fixing holes for the securing bracket with a 4 mm drill and insert the supplied wall plugs. For other types of wall structure alternative fixings may be required (not supplied).
4. Secure the securing bracket to the wall using the supplied fixing screws.

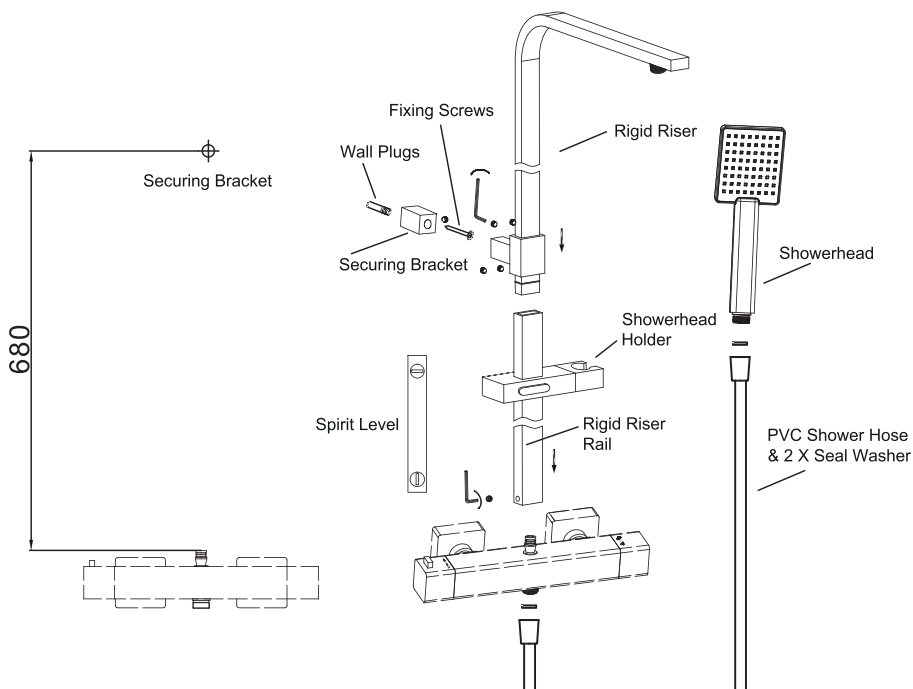

INSTALLATION

Rigid Riser Assembly Installation

1. Slide the securing bracket cover over the rigid riser. Holding the securing bracket cover, insert the rigid riser overhead pipe into rigid riser and then tighten the grub screw. Slide the securing bracket cover to a suitable position and then secure it by tightening the grub screw.
2. Pressing the sleeve, slide the showerhead holder over the rigid riser. Once in position, release the sleeve to secure the holder.

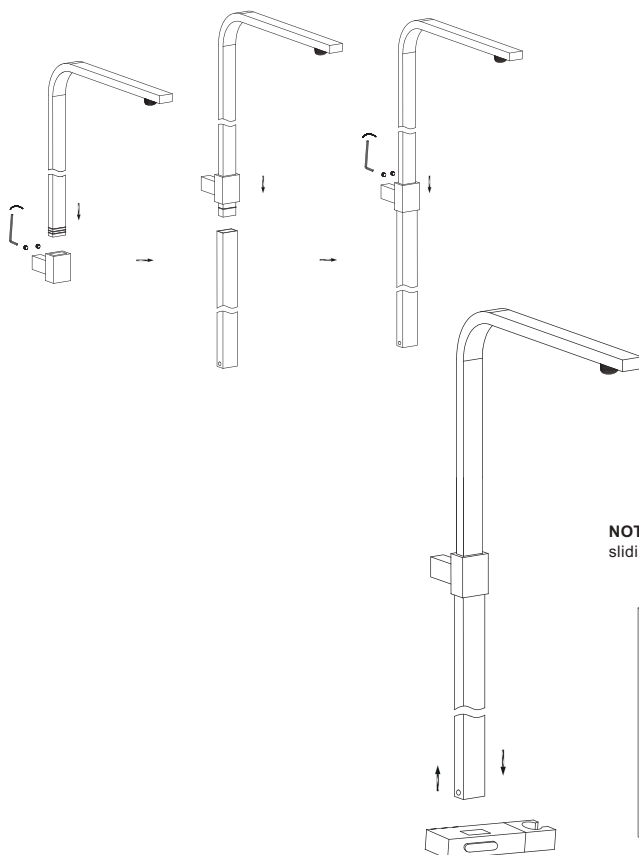

FAULT DIAGNOSIS

Symptom:

- Only hot or cold water from the mixer outlet.
- Outlet temperature too hot / too cold.

Cause/ Rectification:

- Inlets reversed (hot supply to cold supply) - Rework inlet pipework.
- No hot or cold water reaching the mixer - Check the filters for any blockage.
- Installation conditions outside operating parameters, refer to sections: 'Specifications' and 'Commissioning'

Symptom:

- Fluctuating or reduced flow rate.

Cause/ Rectification:

- Check the showerhead, hose and filters for any blockage.
- Make sure that the maintained inlet pressures are nominally balanced and sufficient, refer to section: 'Specifications'.
- Make sure that the inlet temperature differentials are sufficient, refer to section: 'Specifications'.
- Flow regulator fitted incorrectly.
- Air lock or partial blockage in the pipework.

Symptom:

- Water leaking from showerhead.

Cause/ Rectification:

- Normal for a short period after shut off.
- Check that the pressures are not in excess of the specifications for the product.
- Cartridge inlet seals damaged, renew.
- Renew the thermostatic cartridge.
- Clean the flow / diverter cartridge by following the instructions on P14, and if this is unsuccessful replace the cartridge.

For any further information please visit
our website at www.bathstore.com

The manufacturer reserves the right to make
technical modifications without prior notice.