

Aero Bath Waste With Overflow

559441/576313

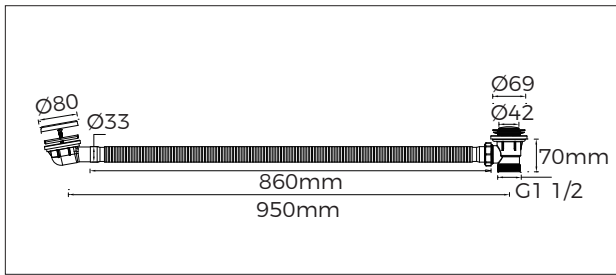

Dimensions:

Width: 950mm (±20mm)

Depth: 80mm (±2mm)

Height: 70mm (±2mm)

Important

General information

We recommend that this product is installed by a qualified tradesperson.

Please check this product immediately to ensure that it has not been damaged and is complete. Before installation, please make sure this product is the correct model and you have all the parts required for installation and use.

Please read these instructions carefully and keep them for future reference.

Important information

If you have an issue or require assistance with this product, then please locate and make a note of the production information located on the product, as shown. Quote these details when speaking to a Bathstore representative.

This is an example of the label for reference only. Please refer to the product for information.

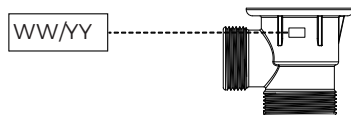

Maintenance

The product should only be cleaned with soapy water, rinsed with clean water, then dried with a soft cloth.

Parts list

No.	Description	Qty
1	Plastic protective case	1
2	Waste body	1
3	Rubber ring	1
4	Rubber seal	1
5	Hose	1
6	Rubber seal	1
7	Plate	1
8	Screw	1
9	Decorative cap	1
10	Plastic protective case	1

Note: remove plastic protective cap (1) and plastic protective case (10) before assembly. These two parts are only for protection.

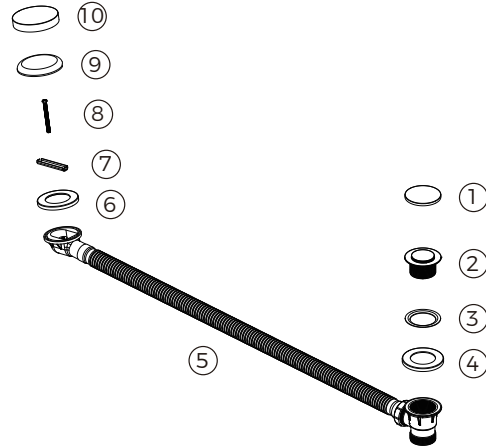

Assembly

- Tighten the waste housing into the retaining nut of hose.
Note: make sure the rubber washer is in place between the waste housing and retaining nut.
- Install the rubber seal (4) into the waste housing and place it into the hole of the bath, underneath.
- Tighten the waste body (2) into the waste housing.
Note: make sure the rubber ring (3) is installed onto the waste body (2).
- Fit the rubber seal (6) onto the overflow housing, then use the screw (8) to fix the support plate (7) and overflow housing, through the overflow hole at an appropriate position. Then fix the decorative cap (9).

