

## Liquid Hinge Door and Side Panel Installation Instructions

Hinge door in alcove (see pages 3 ~ 6)

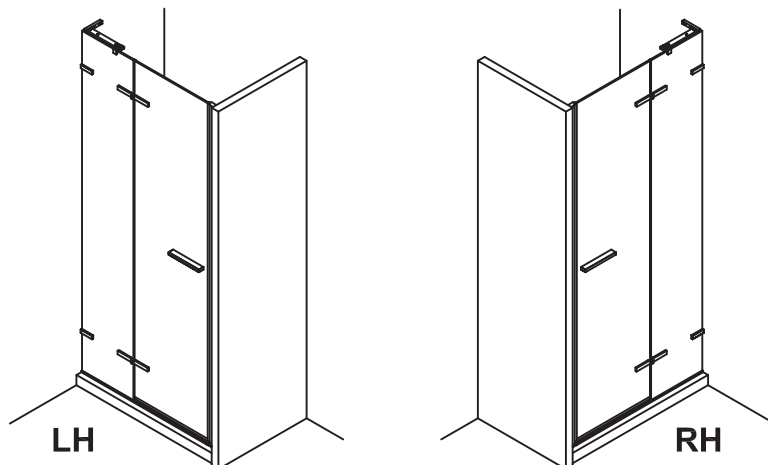

Hinge door + Side panel (see pages 7 ~ 10)

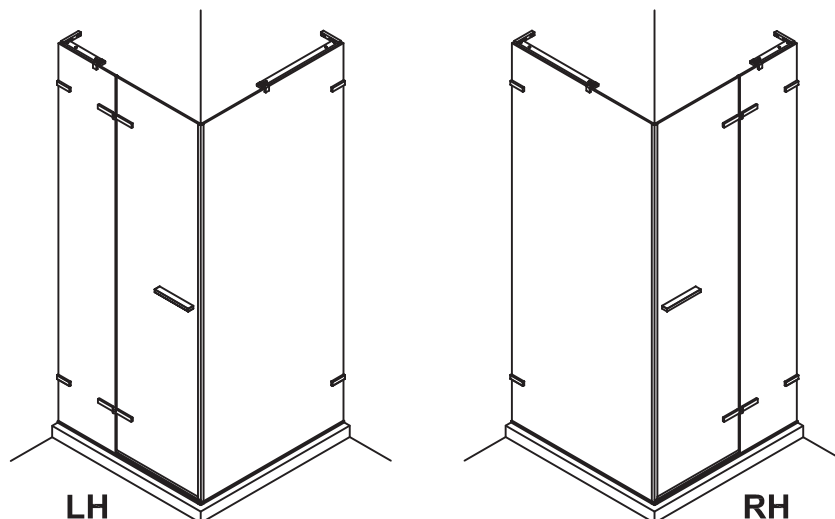

- Prior to installation check that all fittings have been supplied.
  - The tray should be level, the walls should be tiled down to the tray, and the horizontal joint between the tiles and tray must be sealed with silicone sealant to ensure water-tightness.
  - Handle with care. Impacts can damage both the glass and the frame.
  - Please check for any hidden pipes or cables before drilling holes in the wall.
  - The success of the installation and operation is, of course, dependant on the squareness, alignment and construction of the walls to which the enclosure is fixed.
  - The enclosure is reversible: " door can be either left or right opening. "
- In the remainder of this instruction the illustrations will only show the left hand installation of the hinge door.
- The wall fixings supplied may not be suitable for your installation. You may need to source alternatives depending on the construction of the wall you are fixing to.
  - During the installation of the glass panels, the UP/ARROW indicator should always be positioned at the top.
  - Note that all screws which pass through glass are supplied with clear plastic sleeves. It is important that these are fitted as the glass can be badly damaged if unprotected screws are in contact with it.

### Tools Required:

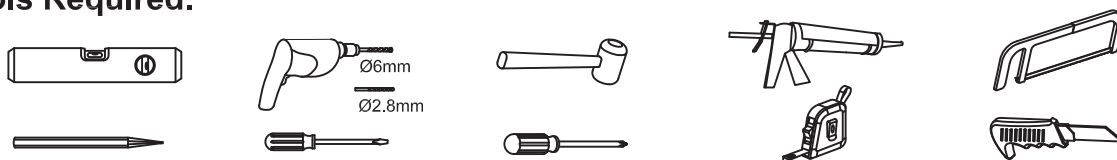

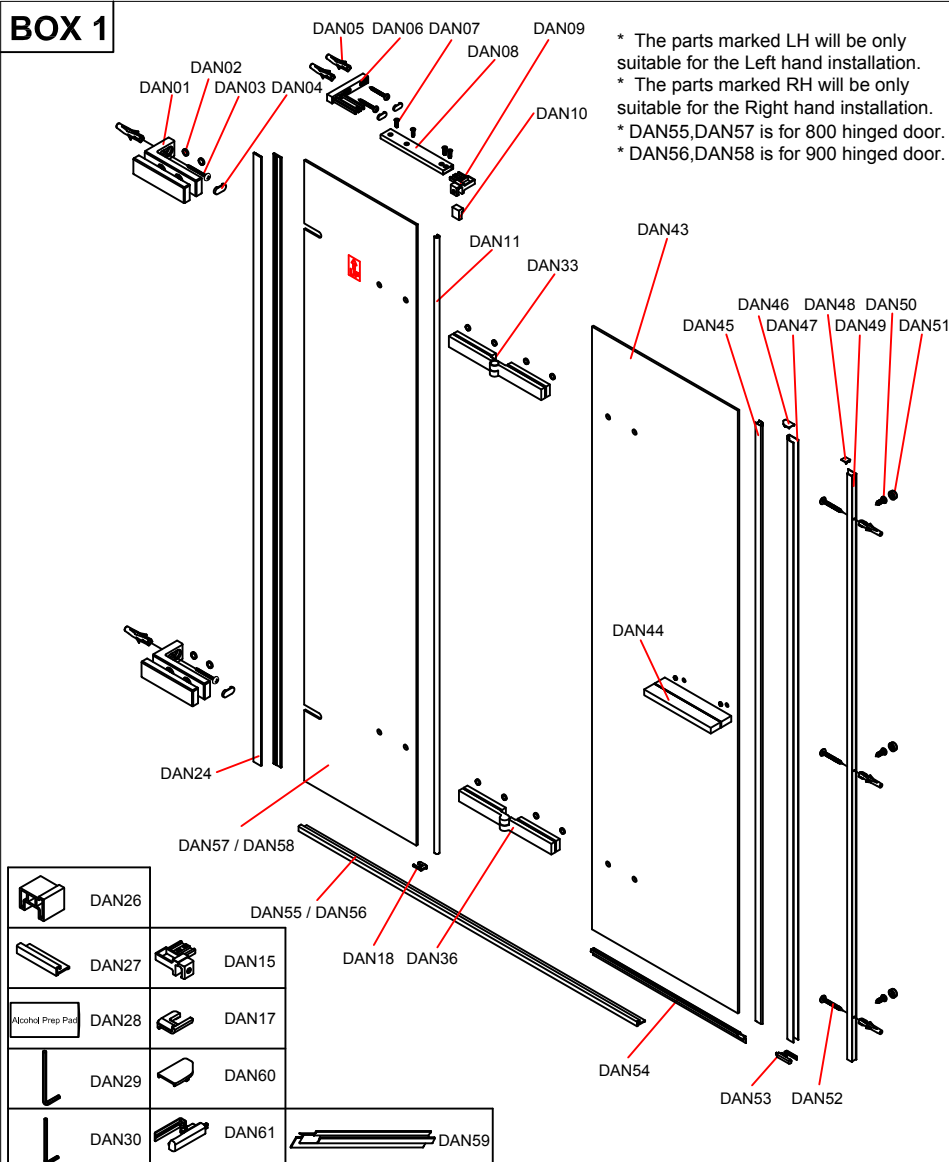
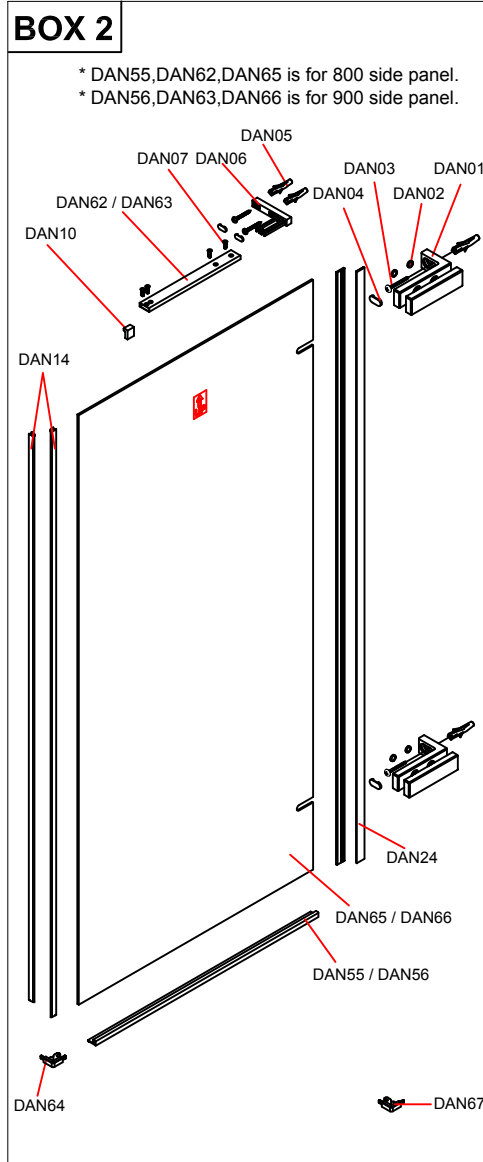
**BOX 1**

**BOX 2**

DAN01 2x	DAN02 14x	DAN03 4x ST5*40mm	DAN04 4x	DAN05 7x	DAN06 1x
DAN07 4x M4*8mm	DAN08 1x	DAN09 1x LH	DAN10 1x	DAN11 1x	DAN33 TOP 1x
DAN43 1x	DAN44 1x	DAN45 1x	DAN46 1x LH	DAN47 1x	DAN48 1x
DAN49 1x	DAN50 3x ST3.5*10mm	DAN51 3x	DAN52 3x ST4*50mm	DAN53 1x LH	DAN54 1x LH
DAN36 BOTTOM 1x	DAN18 1x LH	DAN55/DAN56 1x	DAN57/DAN58 1x	DAN24 2x	DAN59 1x RH
DAN15 1x RH	DAN17 1x RH	DAN60 1x RH	DAN61 1x RH	DAN26 2x	DAN27 1x

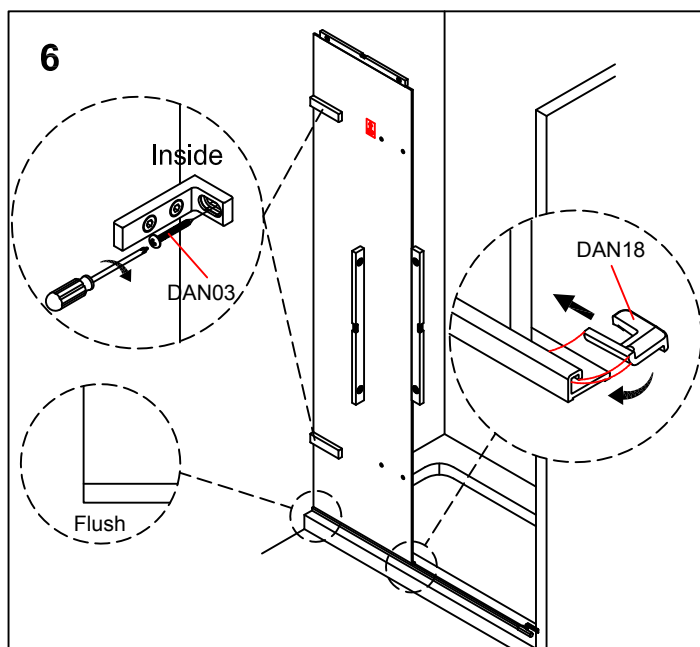
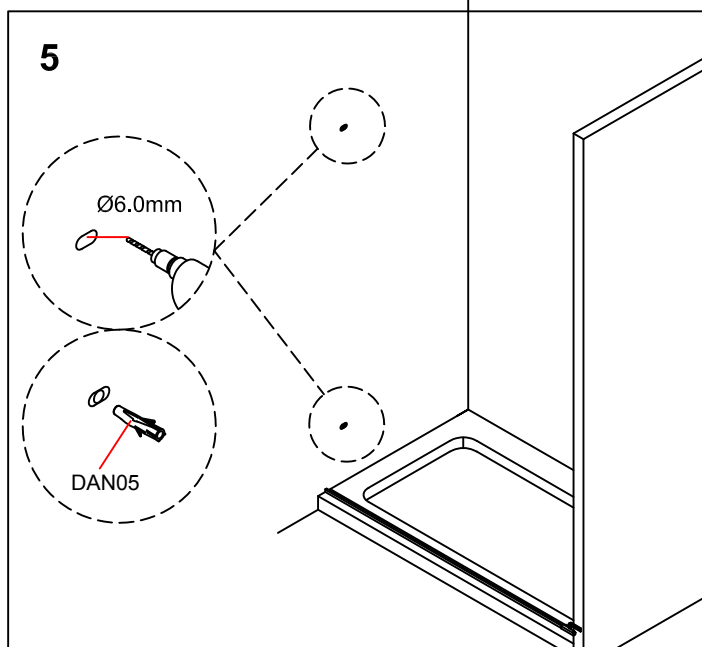
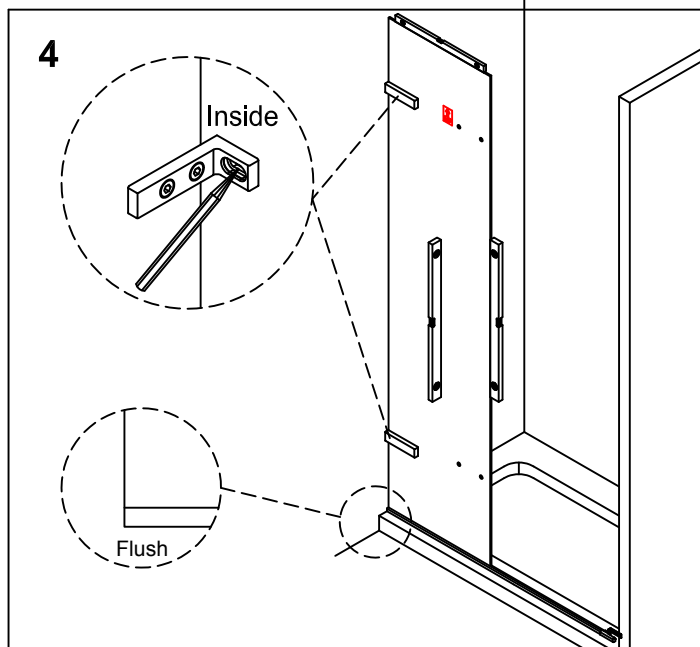
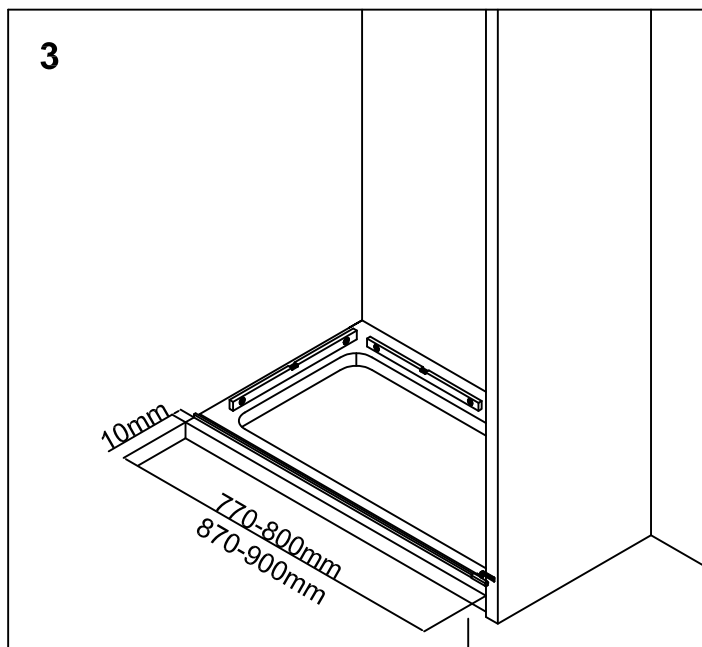
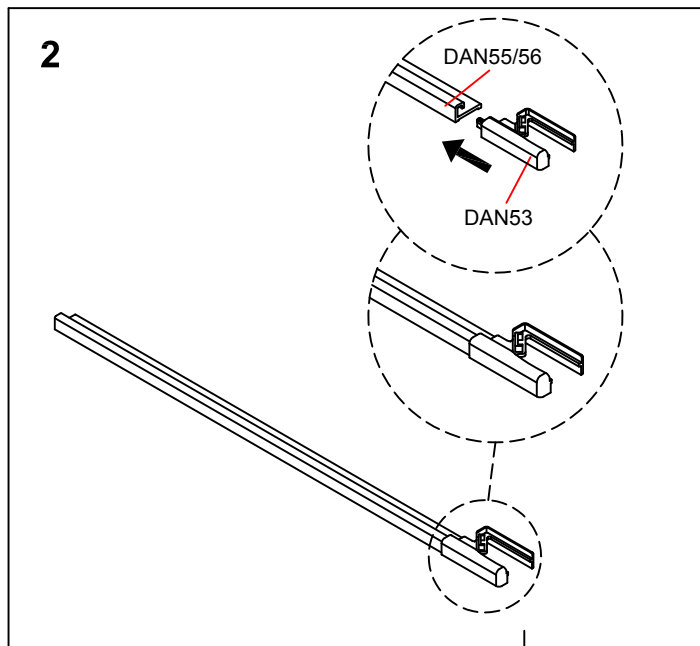
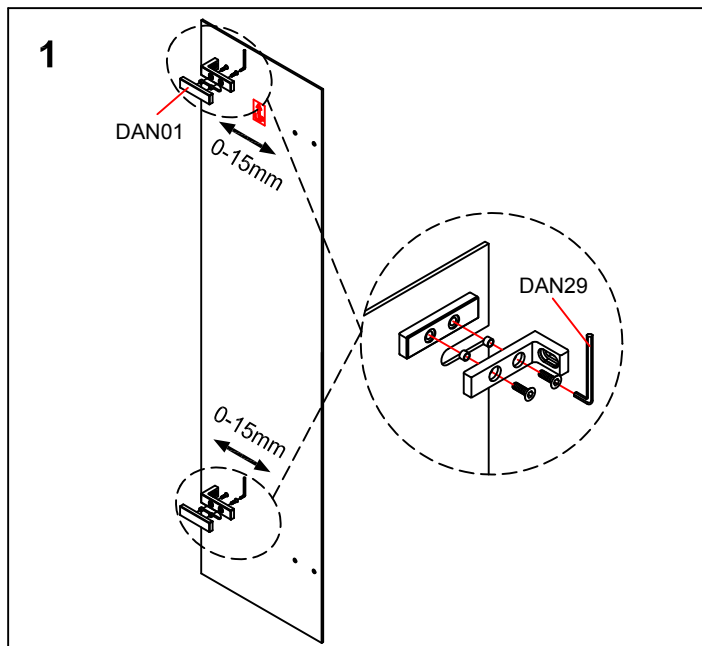
DAN01 2x	DAN02 4x	DAN03 4x ST5*40mm
DAN04 4x	DAN05 4x	DAN06 1x
DAN07 4x M4*8mm	DAN10 1x	DAN24 2x
DAN62/DAN63 1x	DAN14 1x	DAN64 1x LH
DAN55/DAN56 1x	DAN65/DAN66 1x	DAN67 1x RH
DAN28 1x Alcohol Prep Pad	DAN29 1x 4mm	DAN30 1x 2.5mm

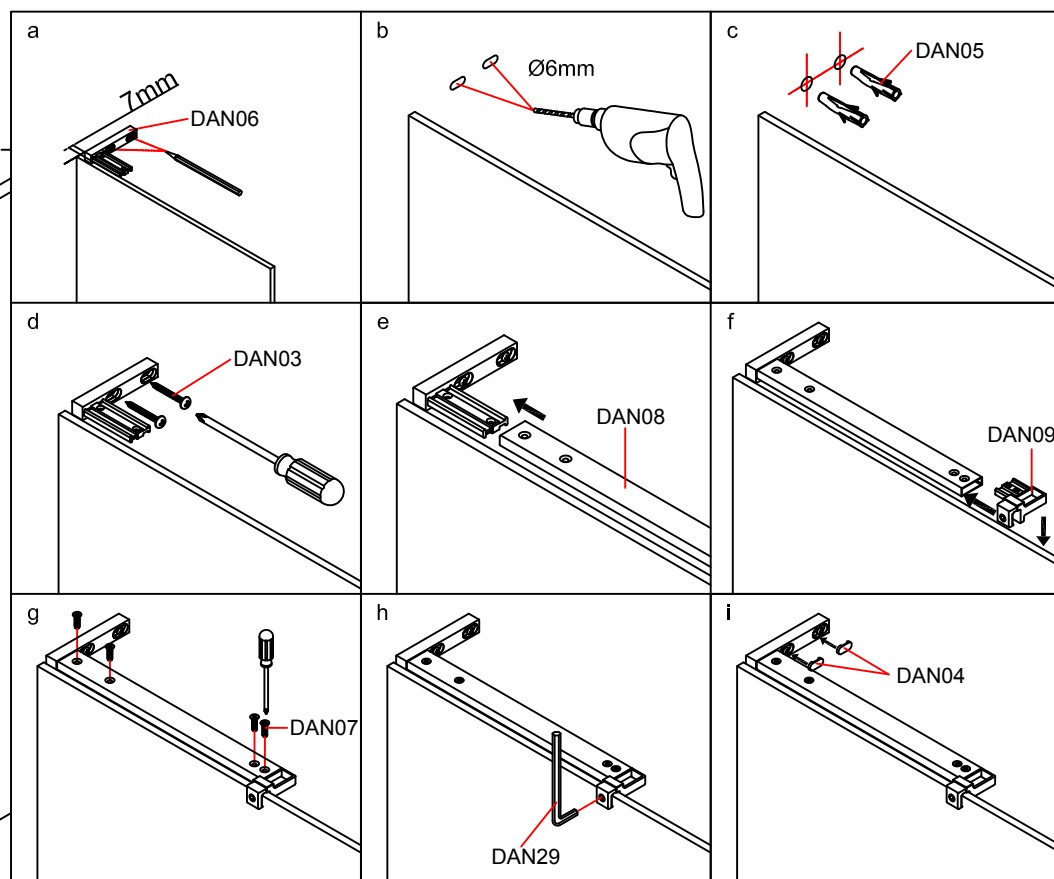

7



8

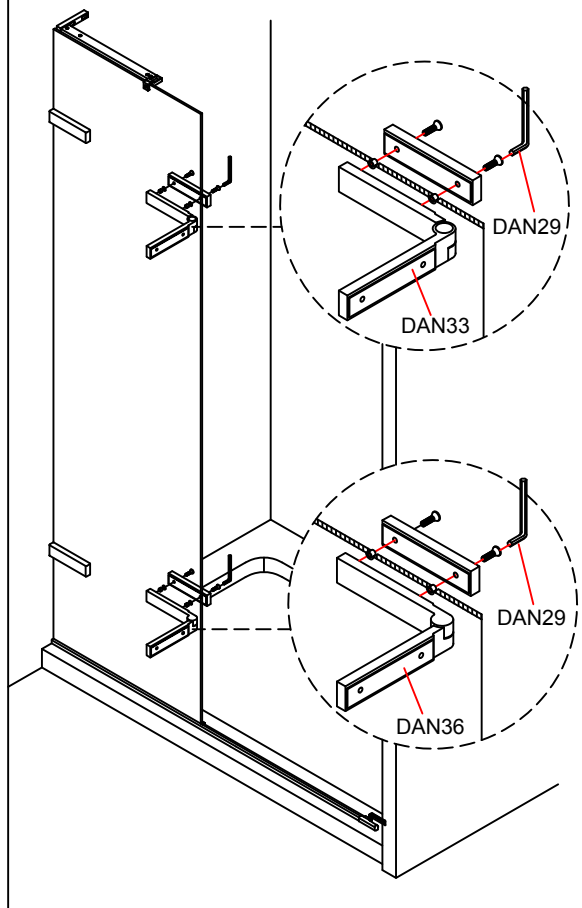

9

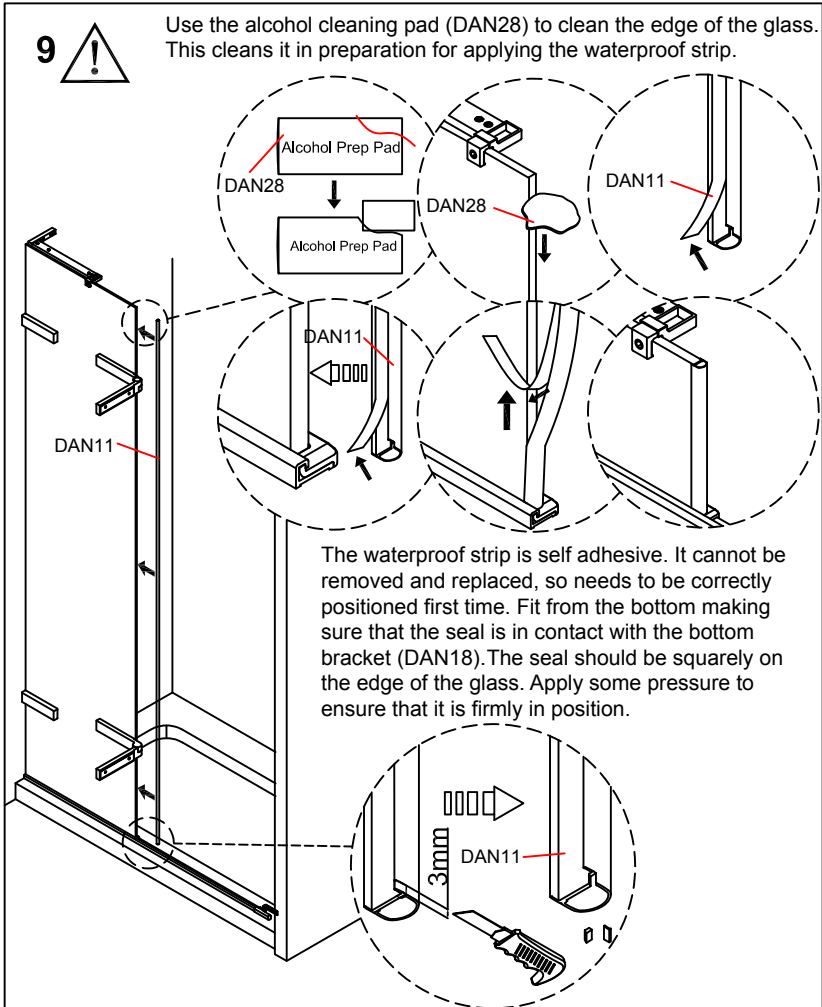

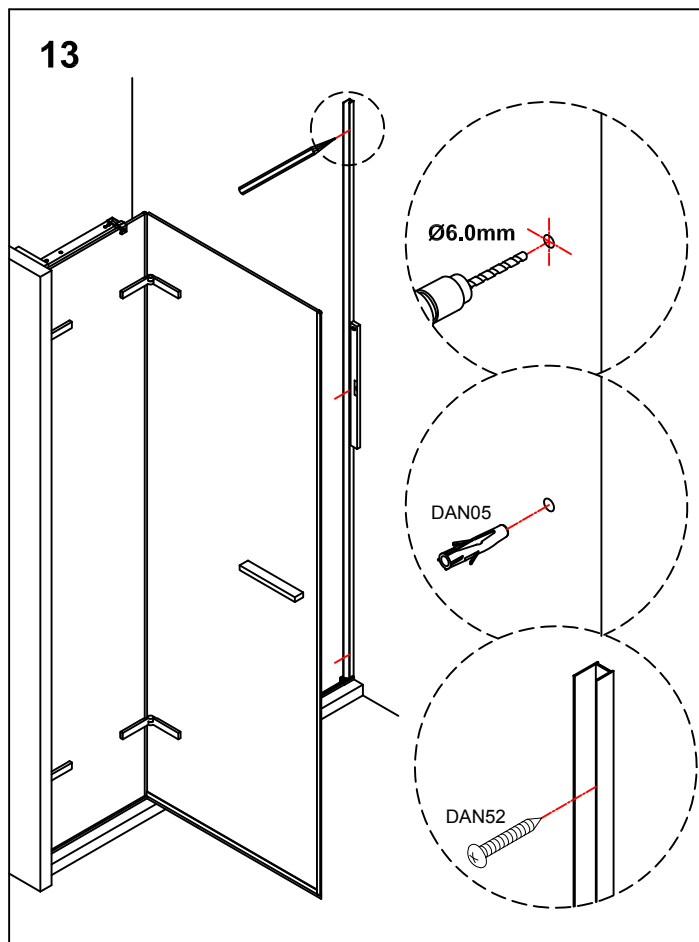
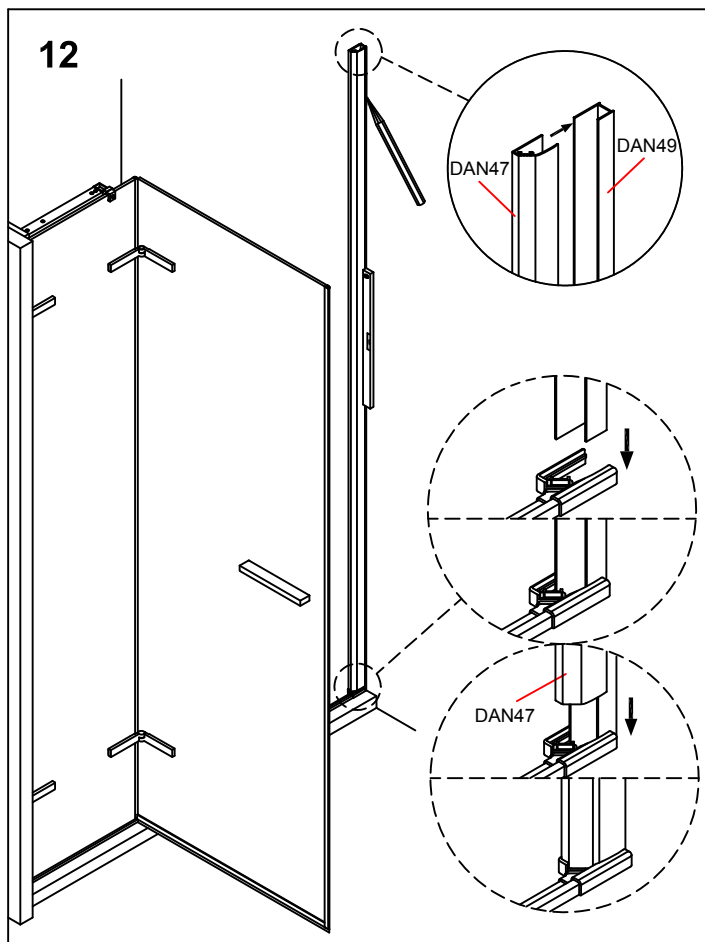
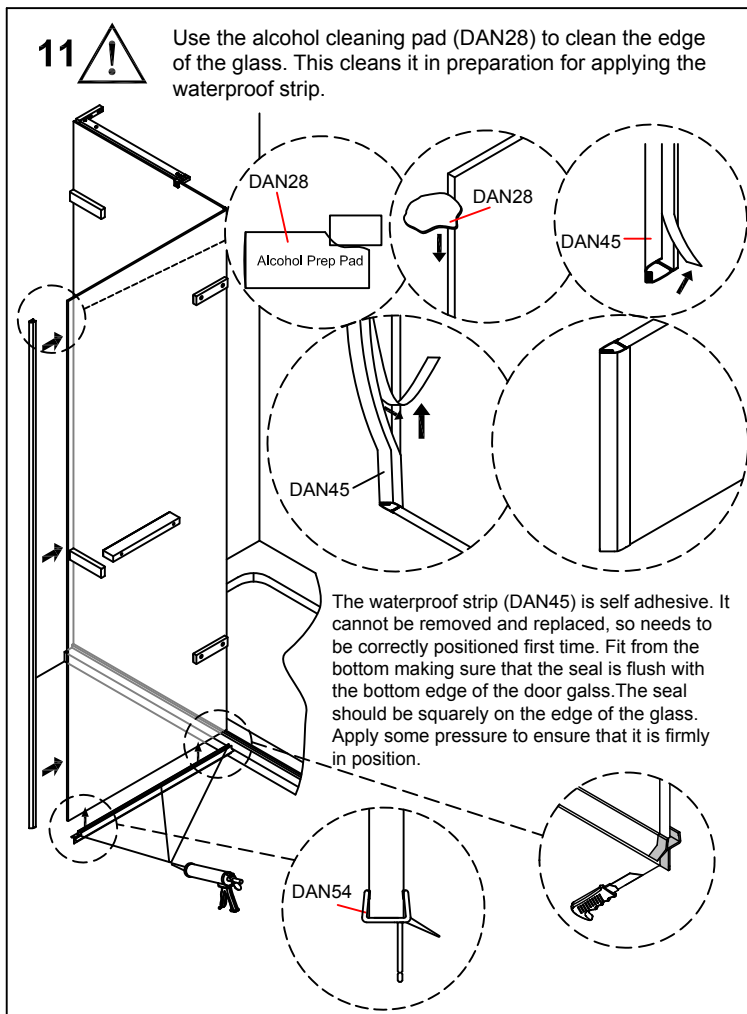
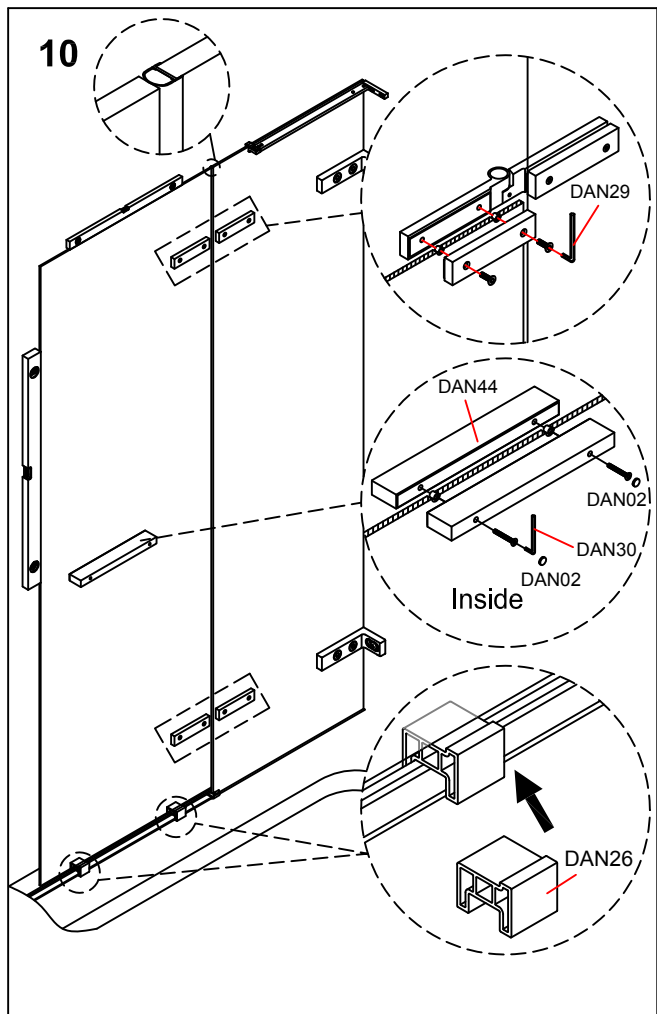

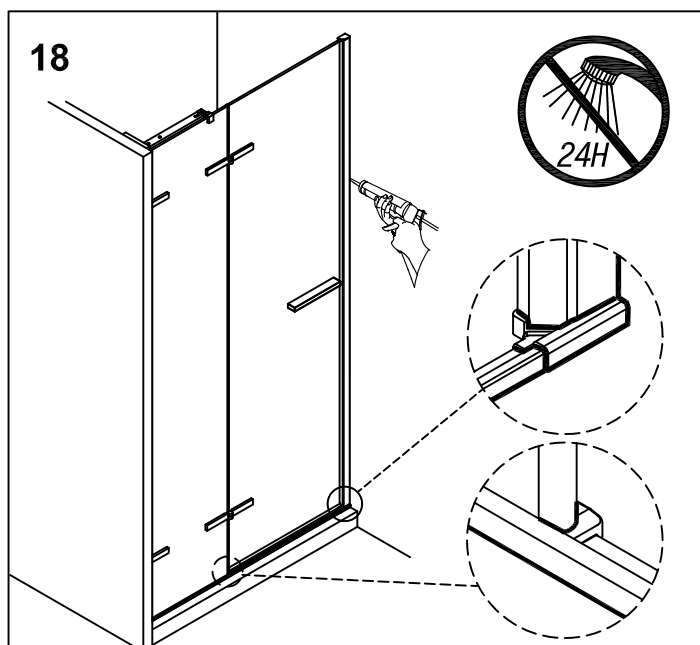
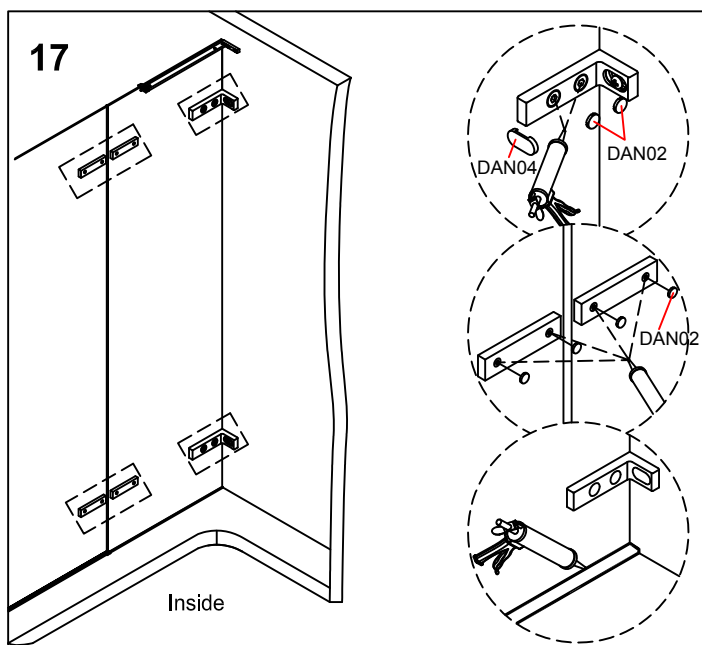
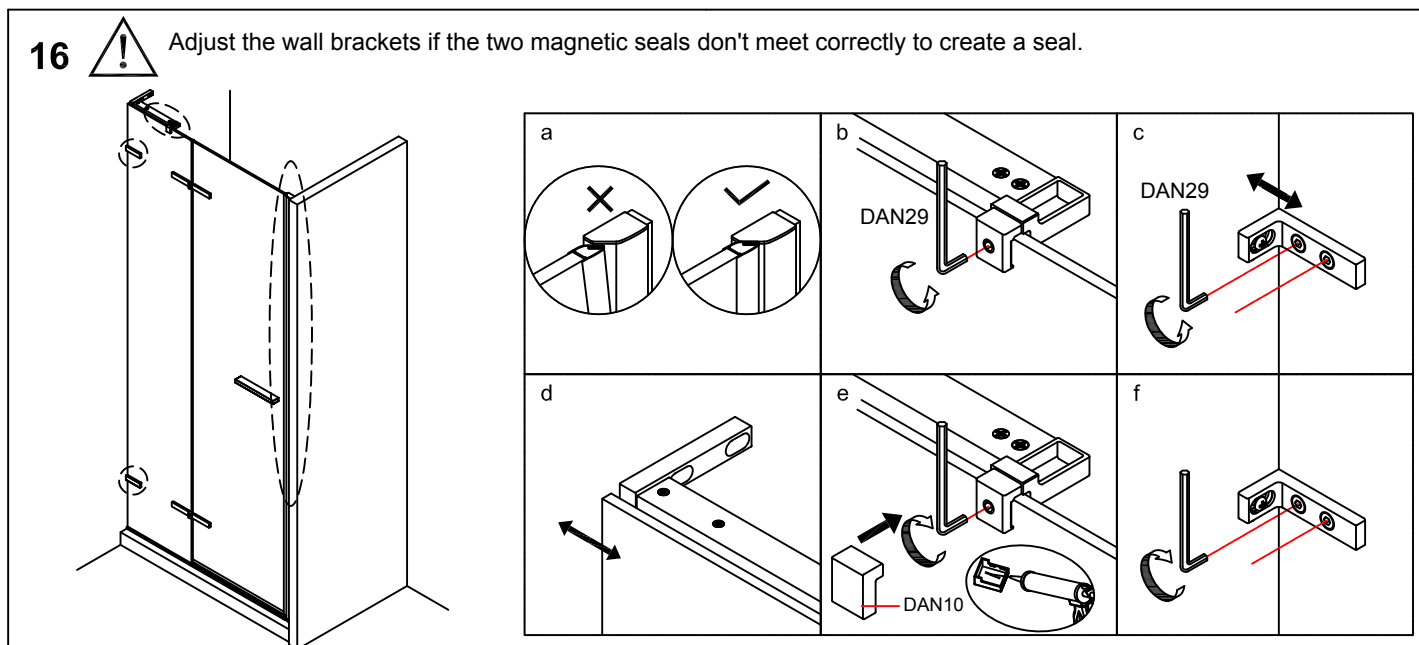
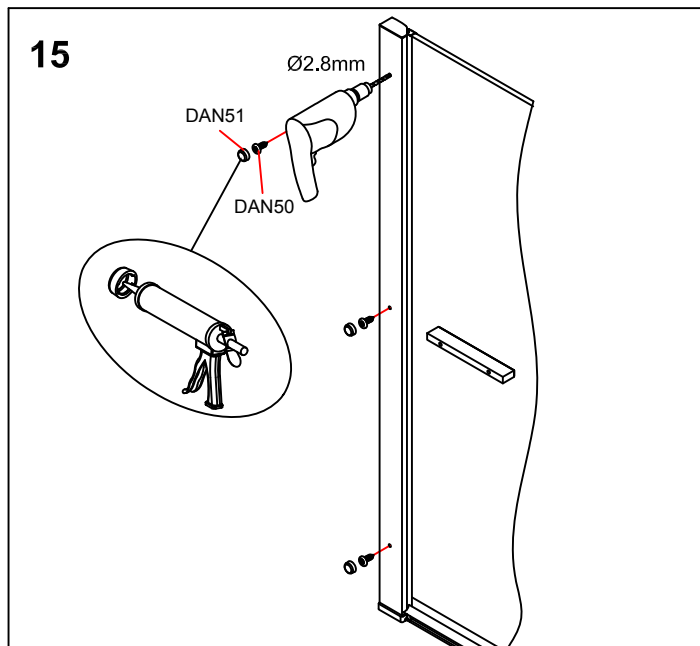
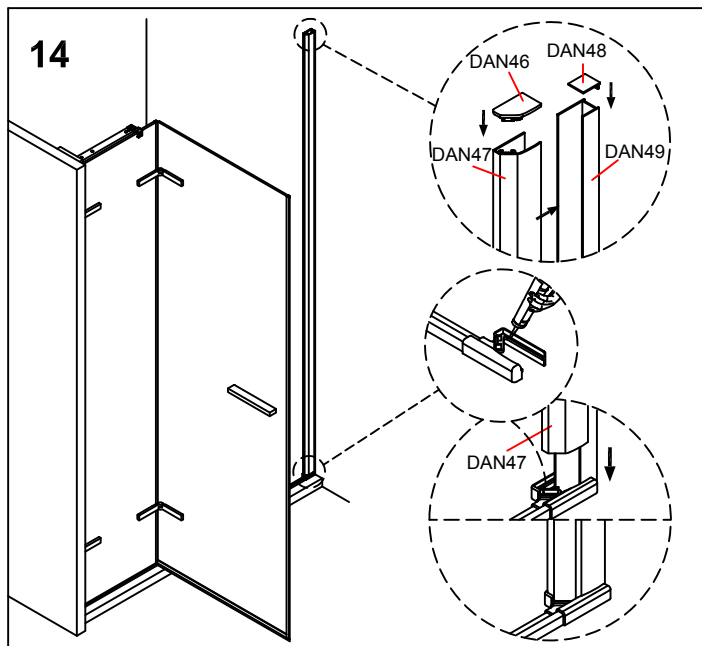

1

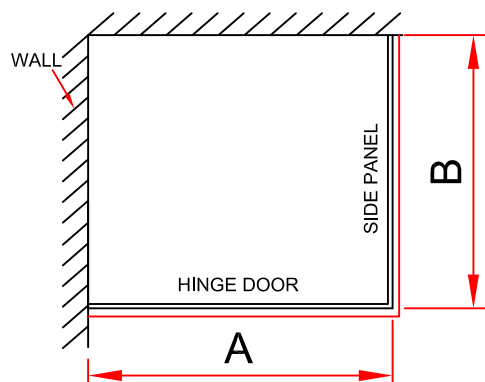

MODEL	A (mm)	B (mm)
800	750~765	750~765
900	850~865	850~865

2

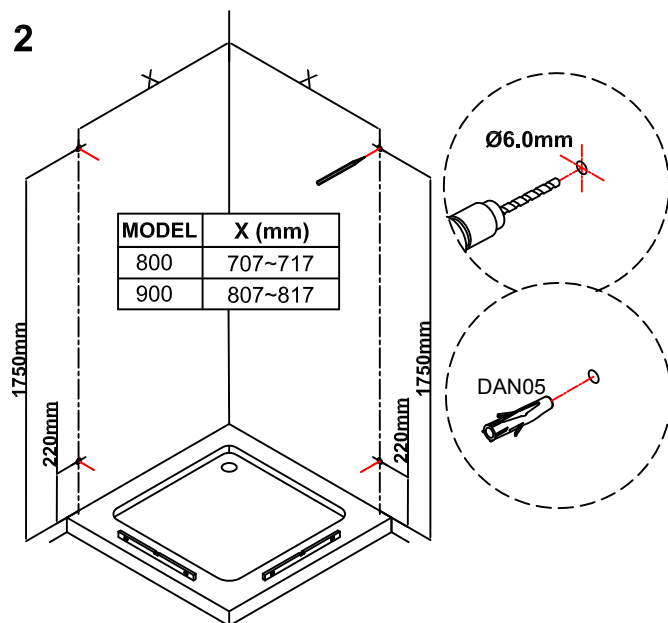

3

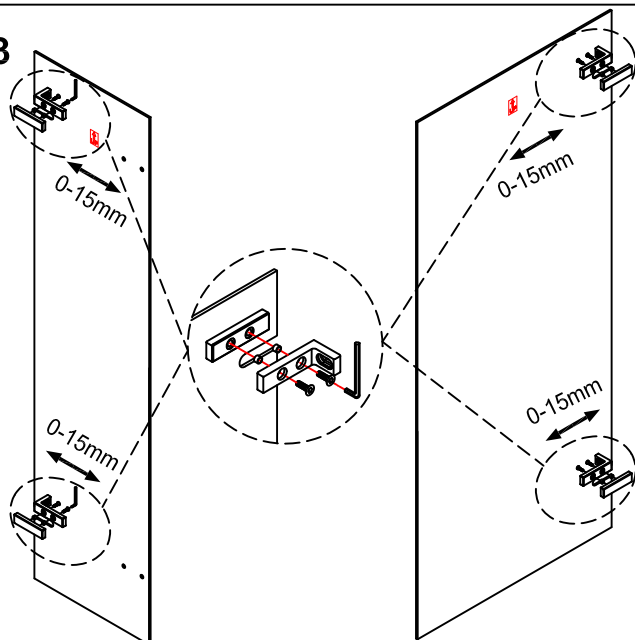

4

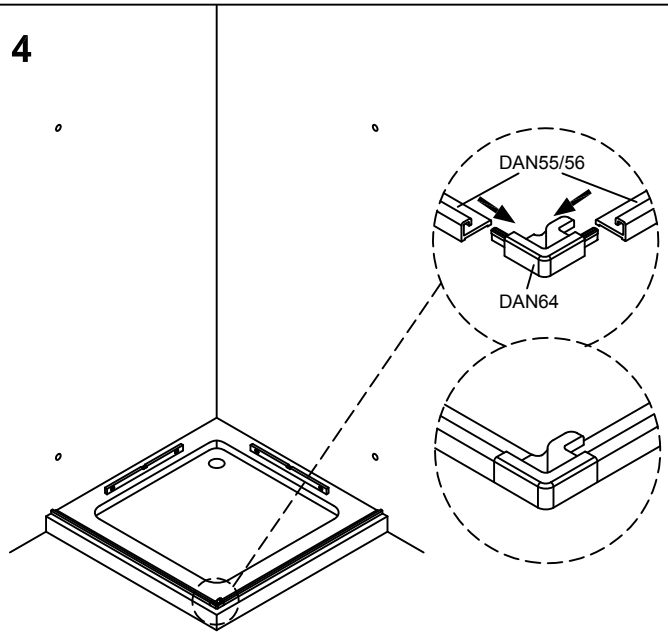

5

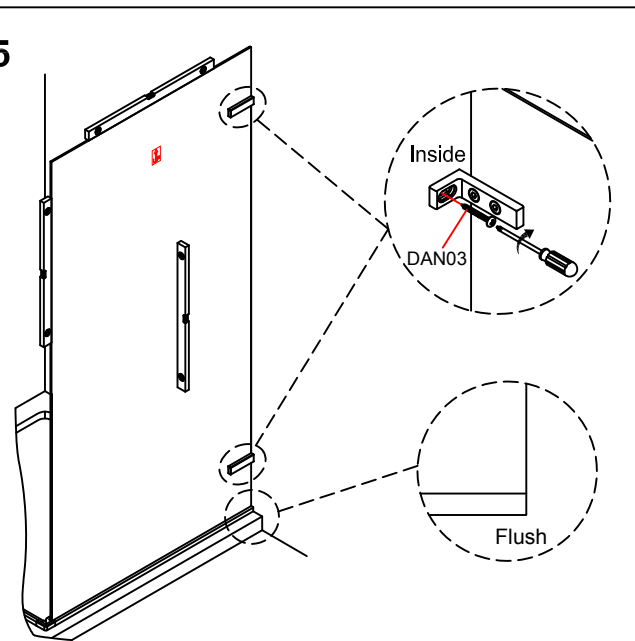

6

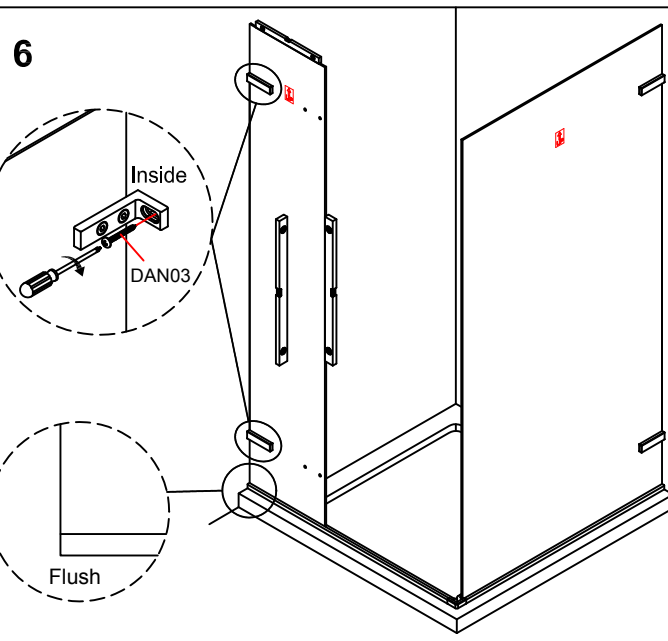



7

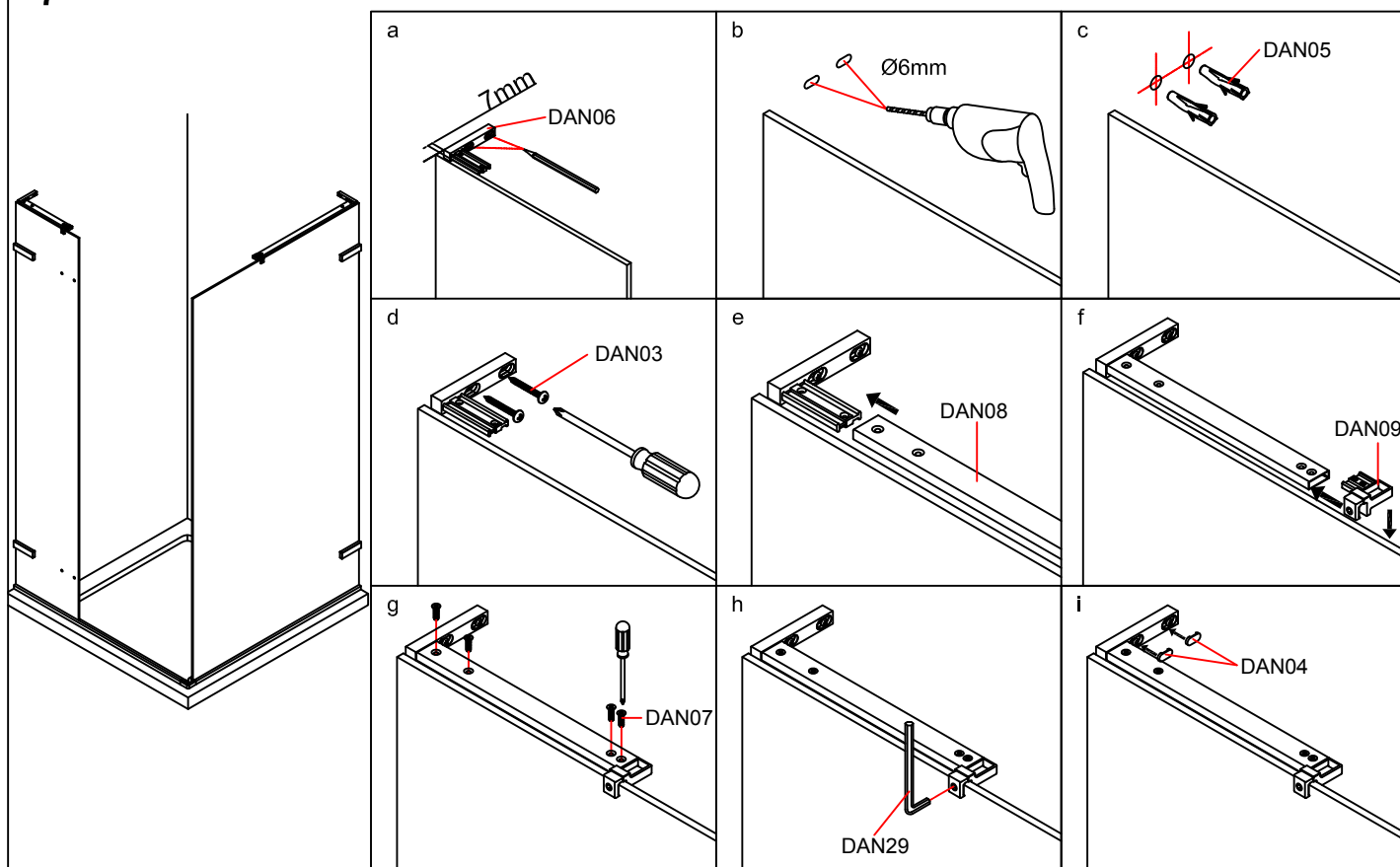

8

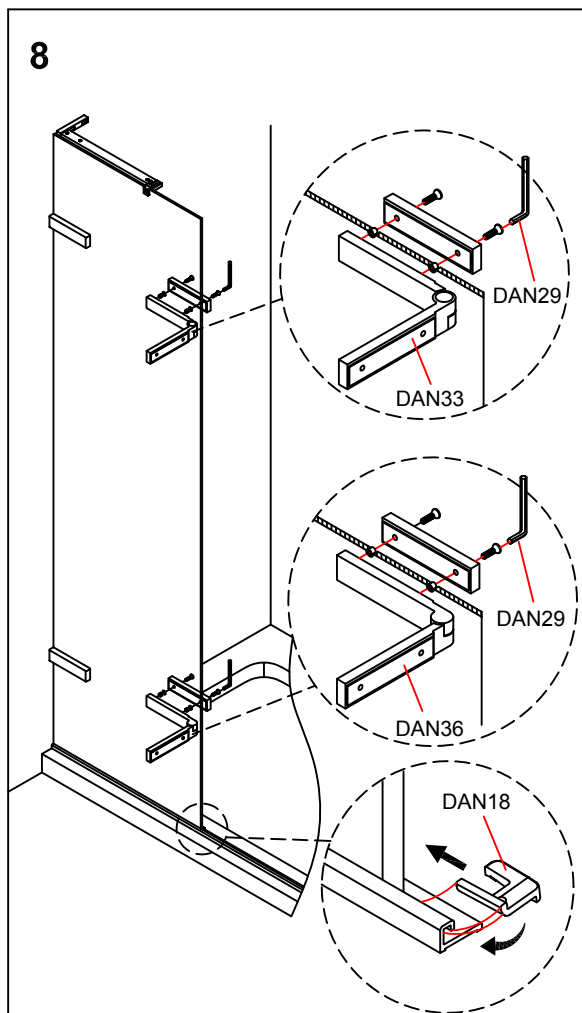

9



Use the alcohol cleaning pad (DAN28) to clean the edge of the glass. This cleans it in preparation for applying the waterproof strip.

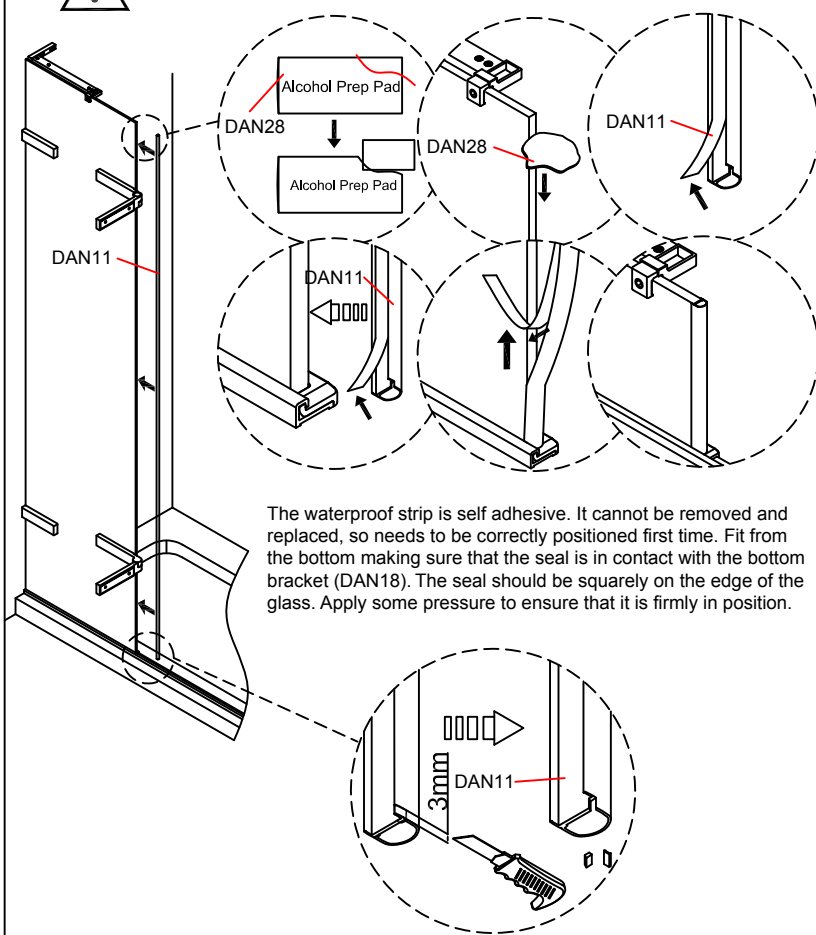



10 

Use the alcohol cleaning pad (DAN28) to clean the edge of the glass. This cleans it in preparation for applying the waterproof strip.

Fit the longer DAN14 to the fixed panel.

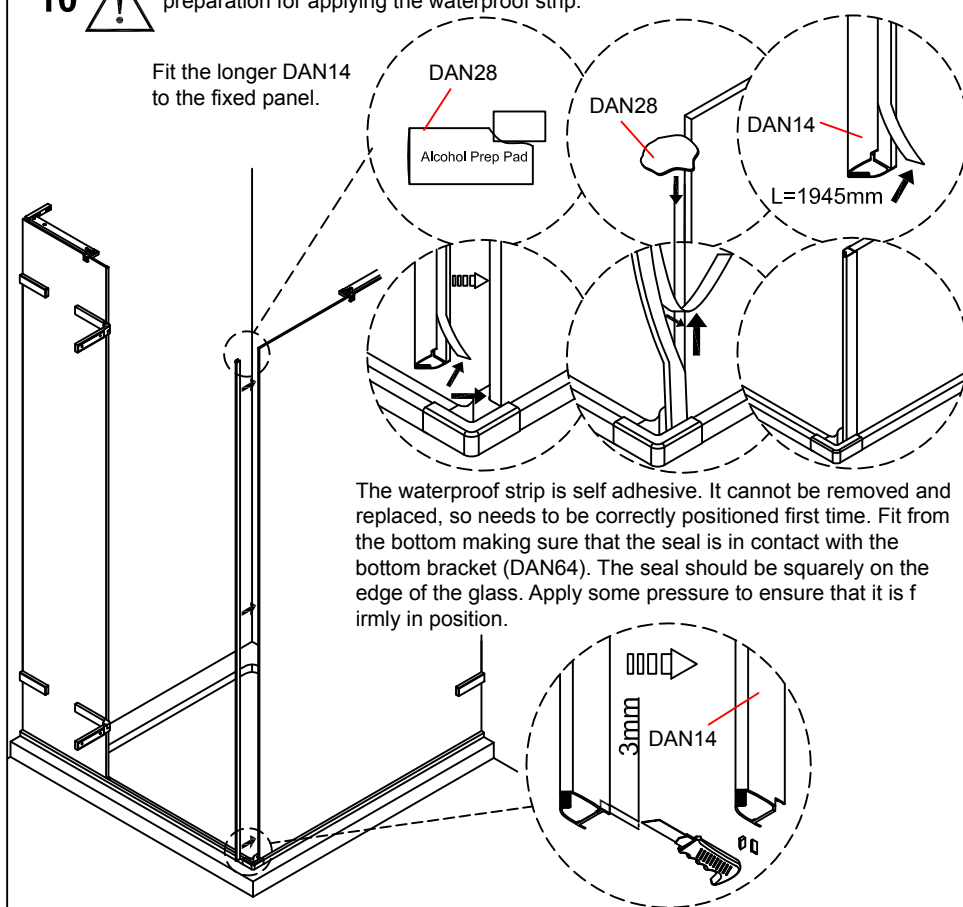

11

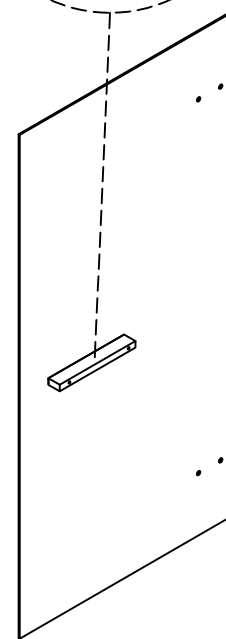
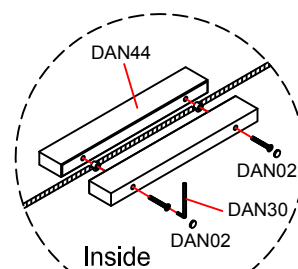

12

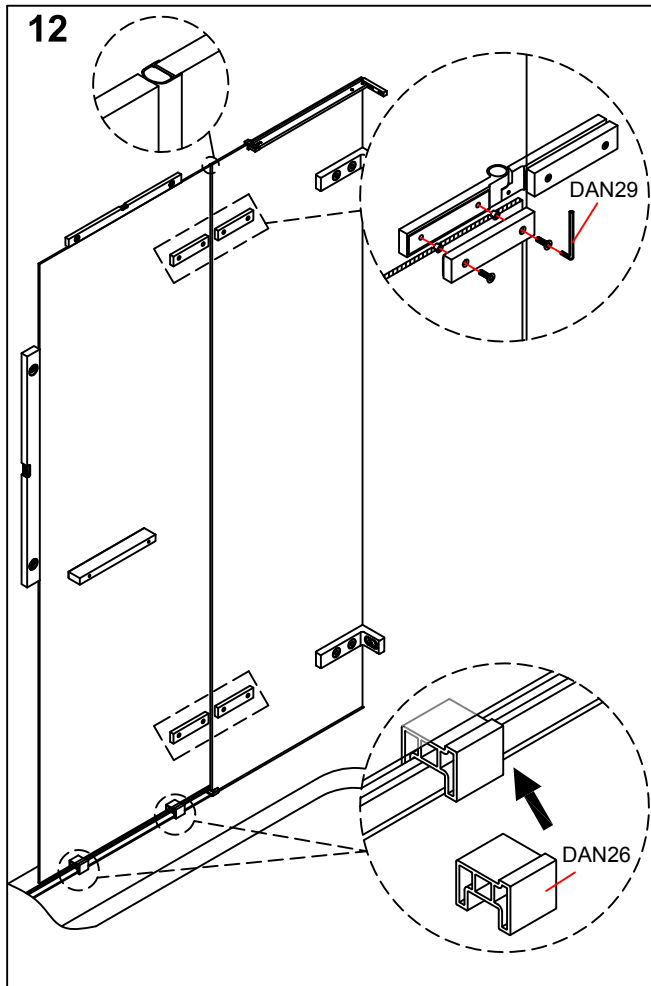

13



Use the alcohol cleaning pad (DAN28) to clean the edge of the glass. This cleans it in preparation for applying the waterproof strip.

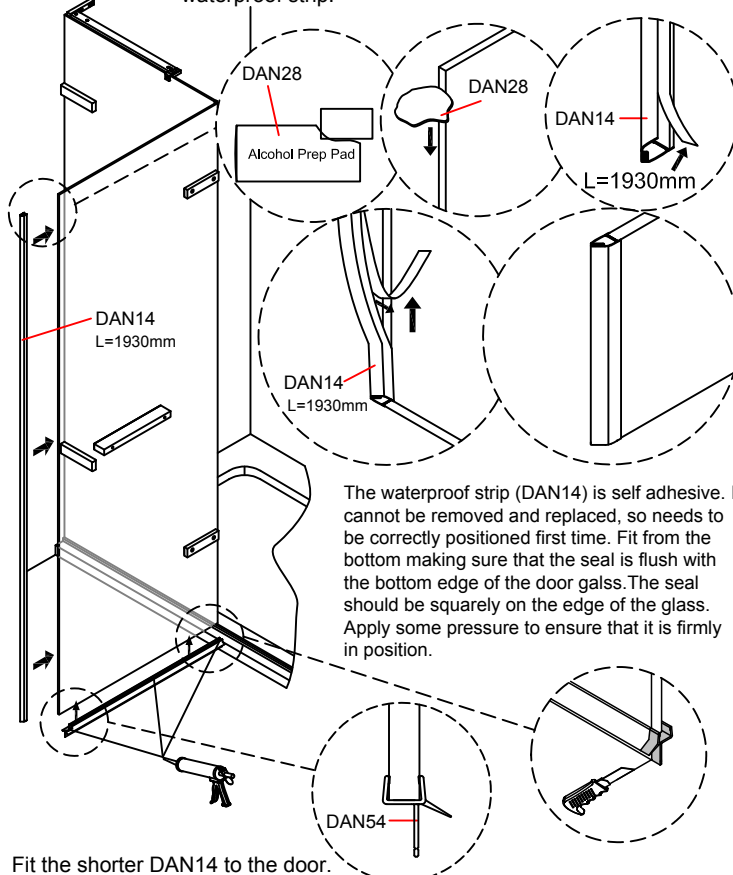

Fit the shorter DAN14 to the door.

14



Adjust the wall brackets if the two magnetic seals don't meet correctly to create a seal.

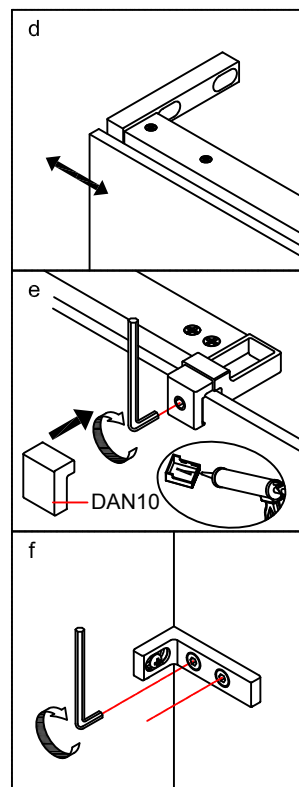
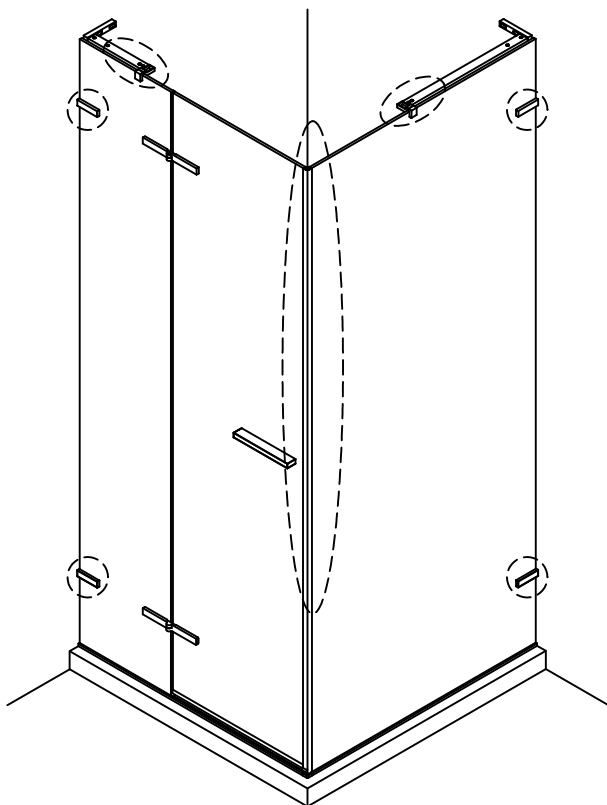
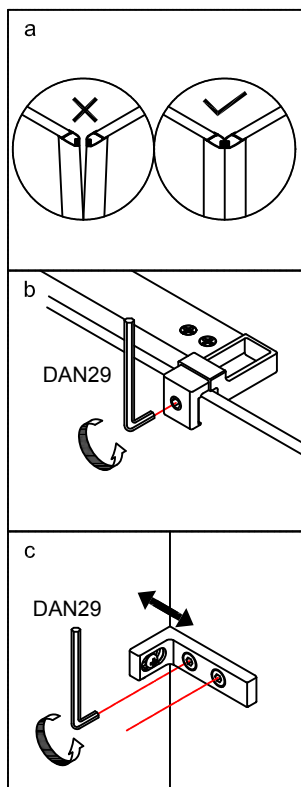

15

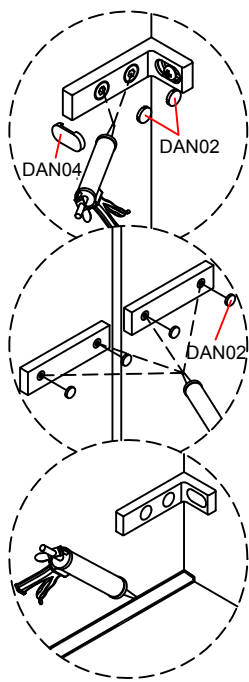
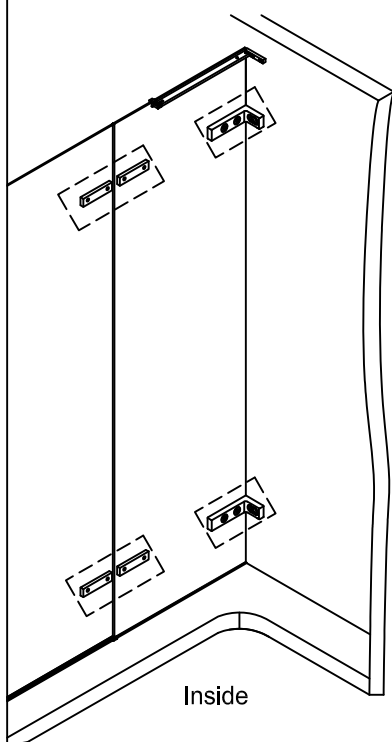

16

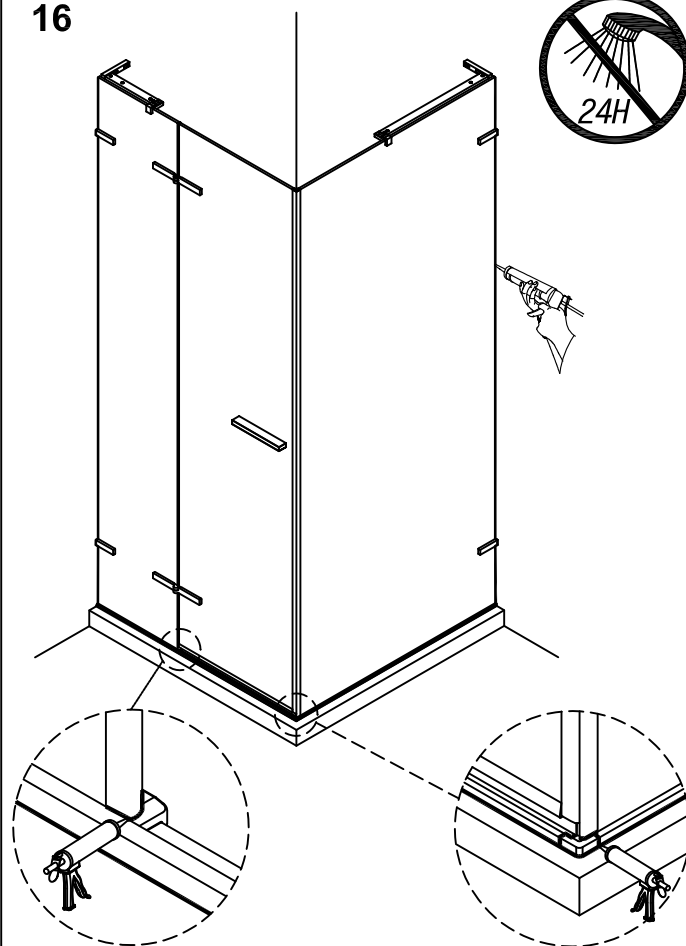

If the gap between the wall and glass is less than 5mm please apply silicone sealer. If the gap exceeds 5mm please follow steps of step 1a-6a.

