

# Bathstore Mino Tall Unit

## IMPORTANT NOTE

Check all product contents and read instructions before starting installation.

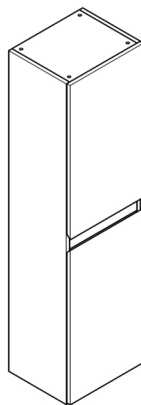

Bathstore Mino Tall Unit  
41405018380

## SAFETY WARNINGS

Handle product with care  
Keep all small parts away from children  
If product is above 20kg (see packaging)  
it requires 2 people to carry & install it

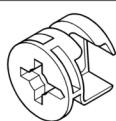

Cam Lock  
x18



Cam Lock Stud  
x18

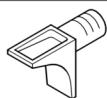

Metal Shelf Peg  
x8

Wooden Dowel  
x26

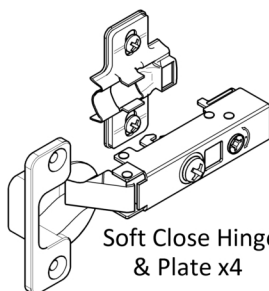
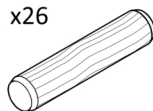

Soft Close Hinge  
& Plate x4

Hanging Bracket  
Cover Cap  
x4



Screws  
x8

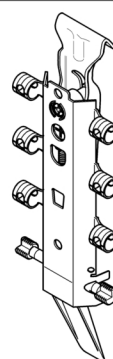

Wall Hanging  
Bracket  
x4

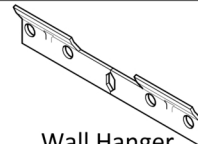

Wall Hanger  
Fixings  
x2

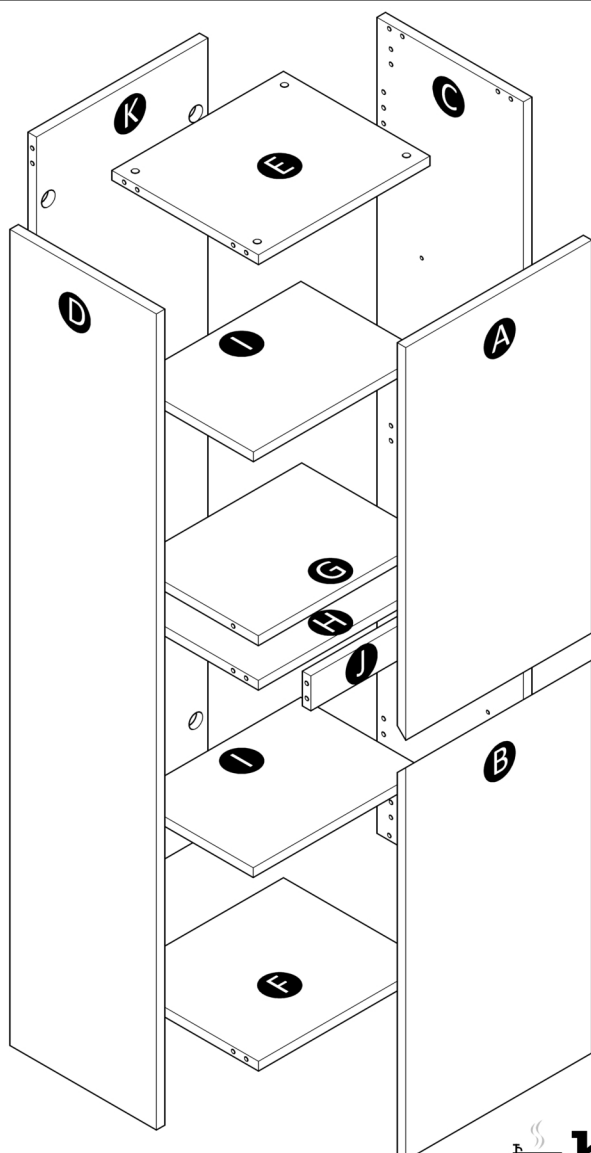

## Note:

Doors can be hung on either side of the unit.  
When the hinges have been fitted to the doors,  
and the hinge hangers have been fitted to the desired side of the unit,  
rotate the doors so the fixings are both on the same side.  
Ensure the door bevelled edges are both in the centre of the unit.

## Tools Required

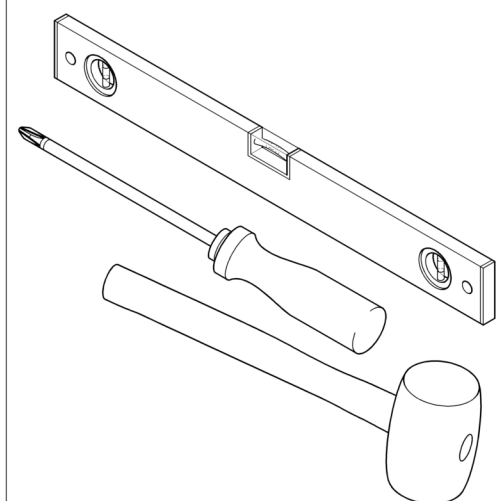

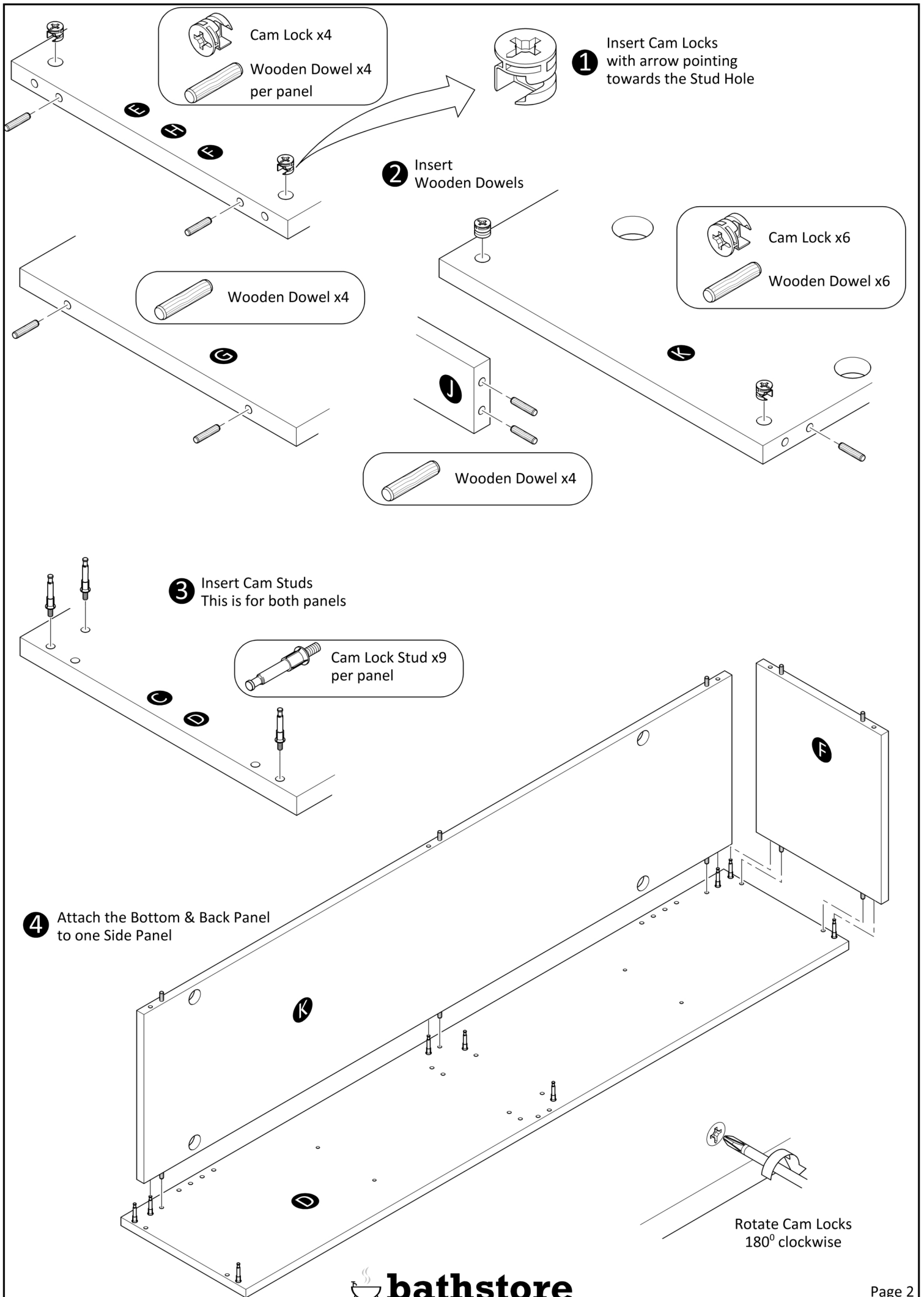

- 5** Attach the Top Panel, Bottom Centre Panel & Front Rail to the assembly

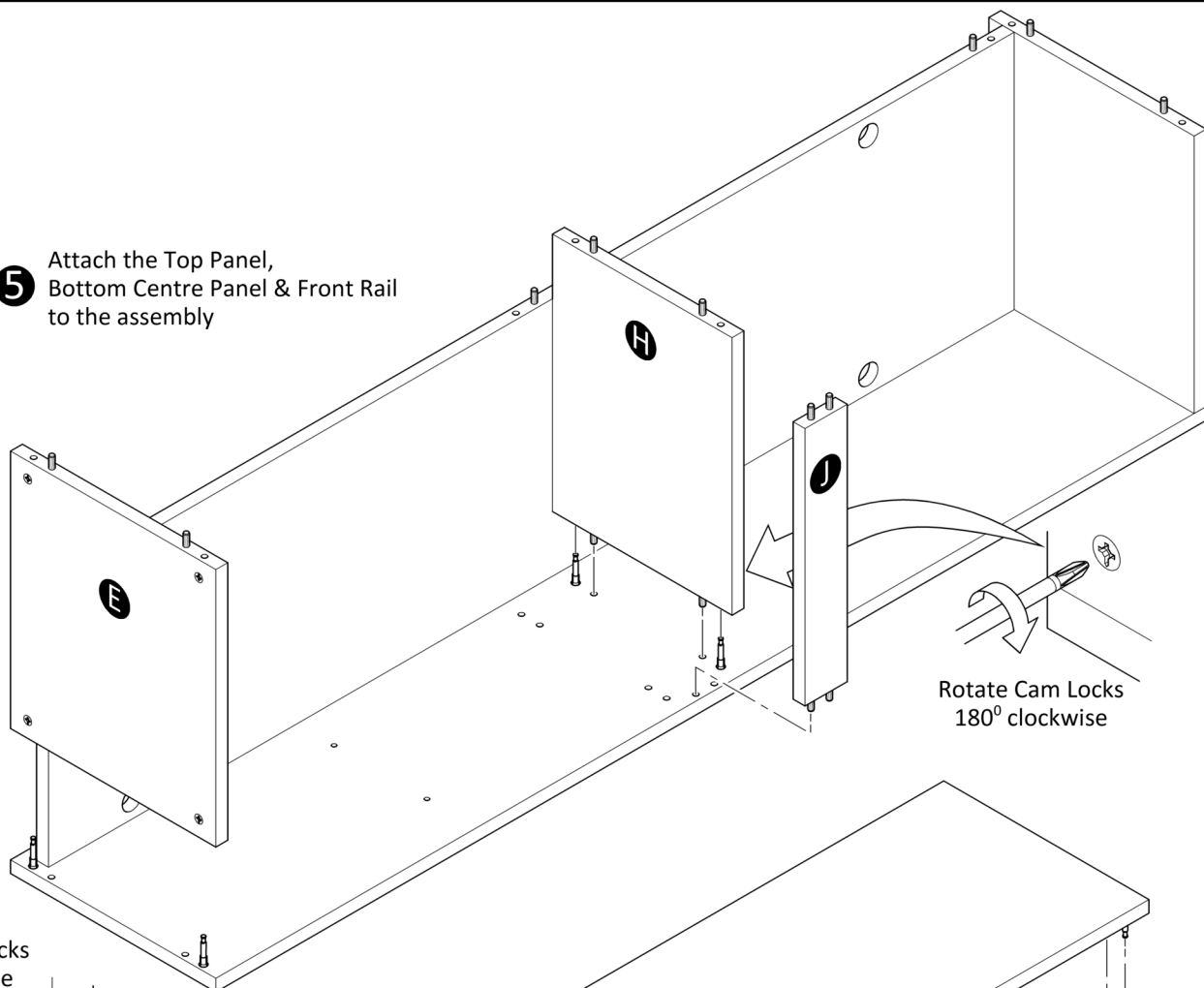

Rotate Cam Locks  
180° clockwise

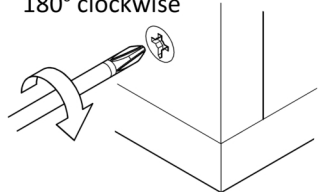

- 6** Attach the Top Centre Panel & remaining Side Panel to the assembly

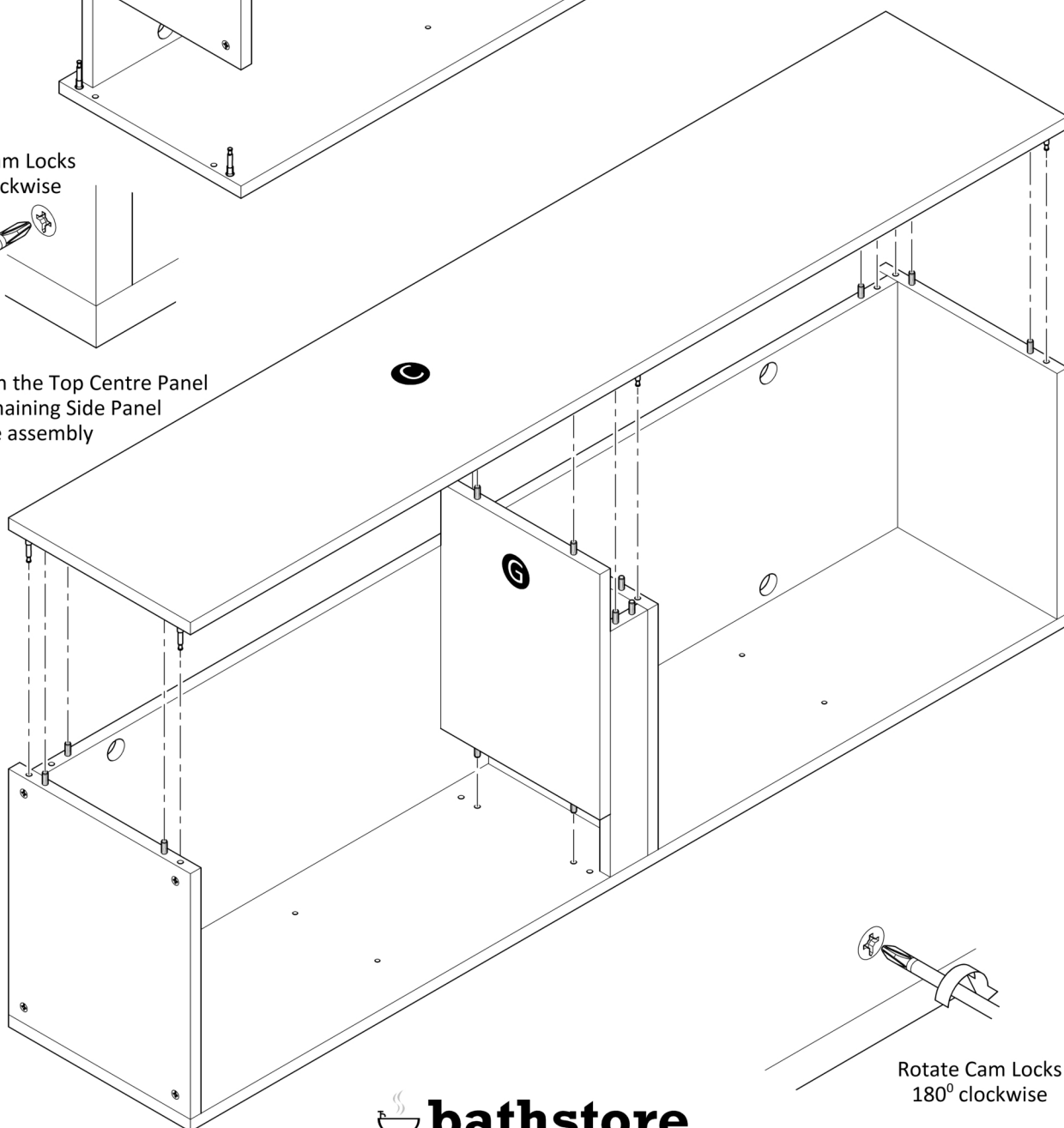

Rotate Cam Locks  
180° clockwise



**bathstore**

- 7** Secure the Hinges x4 to the Doors x2  
Customer to decide which side to hang the doors

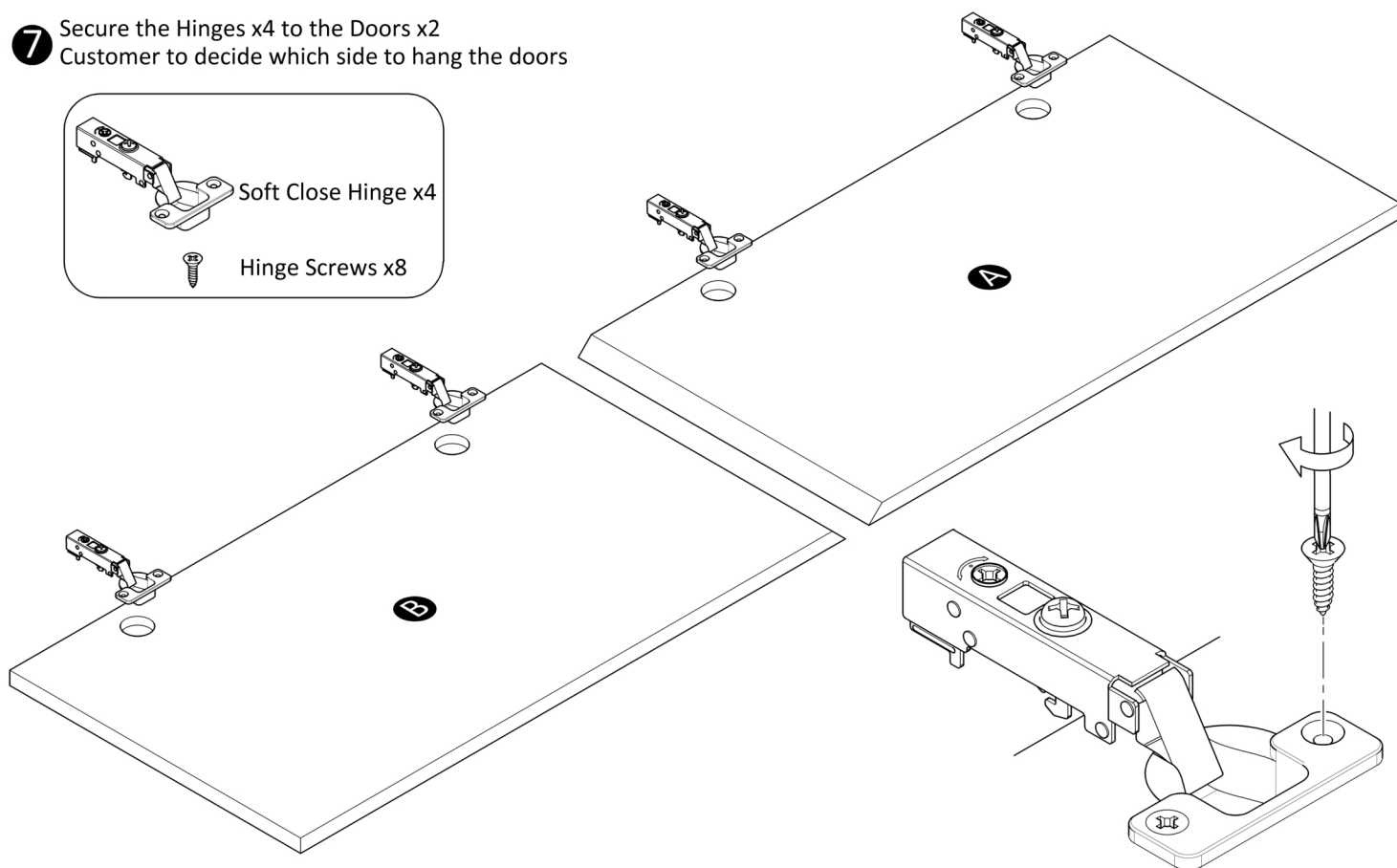

- 8** Secure the Hinge Hangers to the Side Panel  
you would like the doors to be hung on

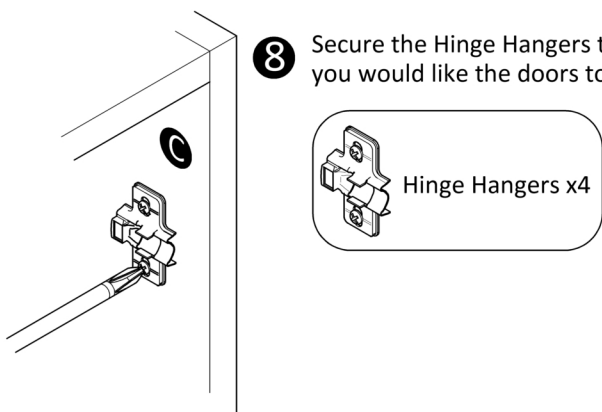

- 9** Push the 4 Wall Hanging Brackets, two per side, into the four holes in each side Panel top and bottom then flip Lock Tab down to secure

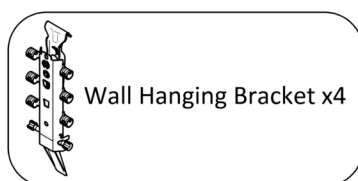

- 10** Break the  
Wall Hanger Fixing  
into two pieces

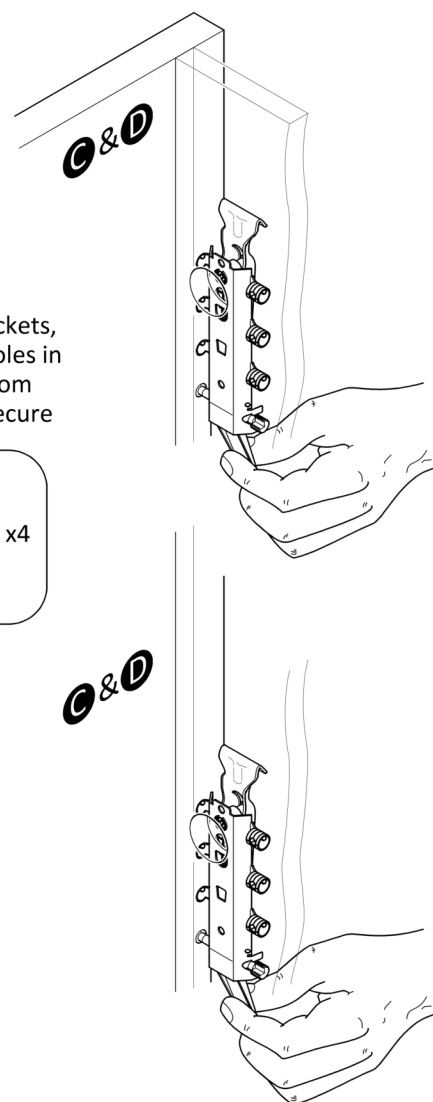
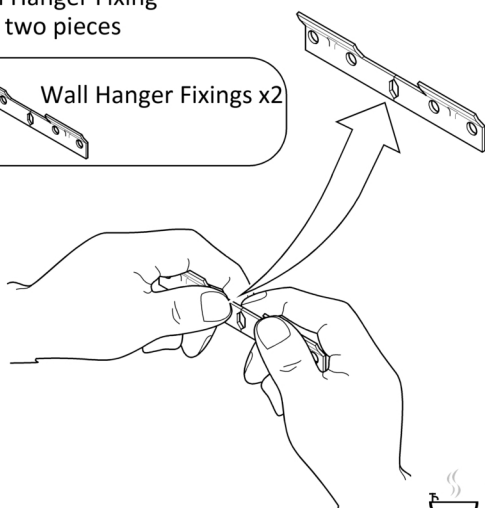

- 11** Mark the wall as shown for Wall Hanger Fixings to be secured

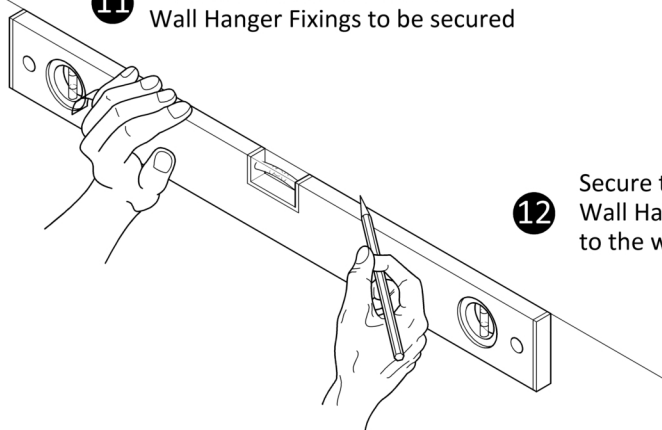

- 12** Secure the Wall Hanger Fixings x4 to the wall

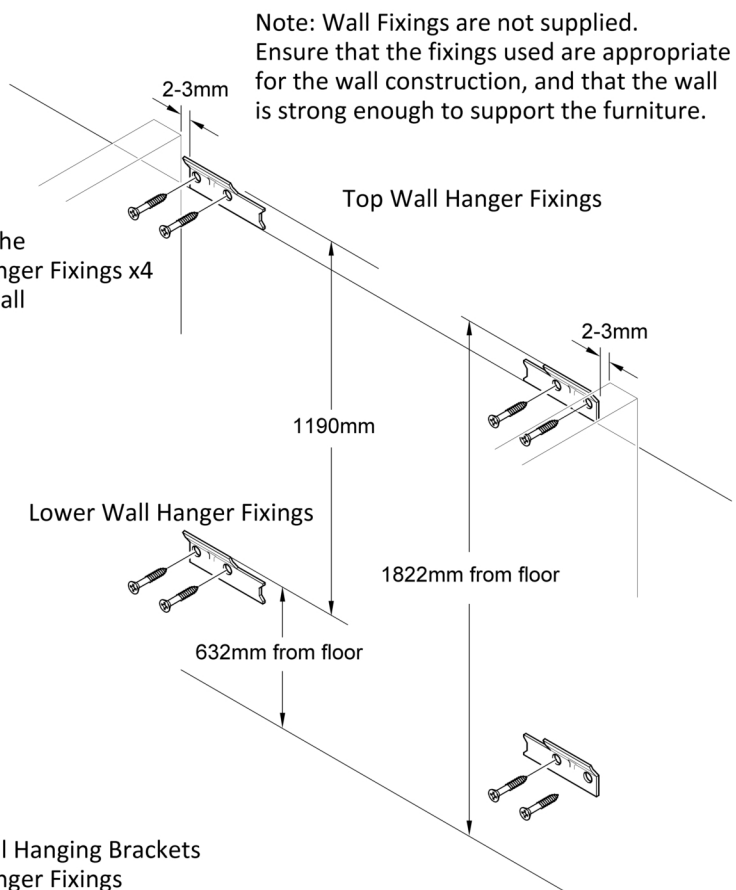

- 13** Hook all four Wall Hanging Brackets over the Wall Hanger Fixings

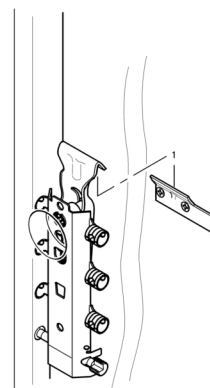
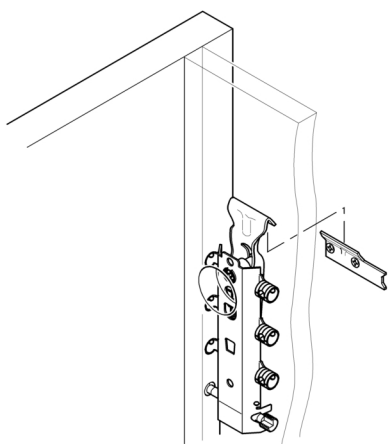

- 14** Adjust Tall Unit as required use all four Wall Hanger Brackets

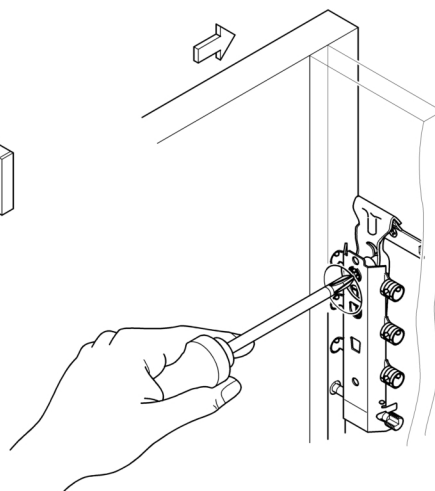
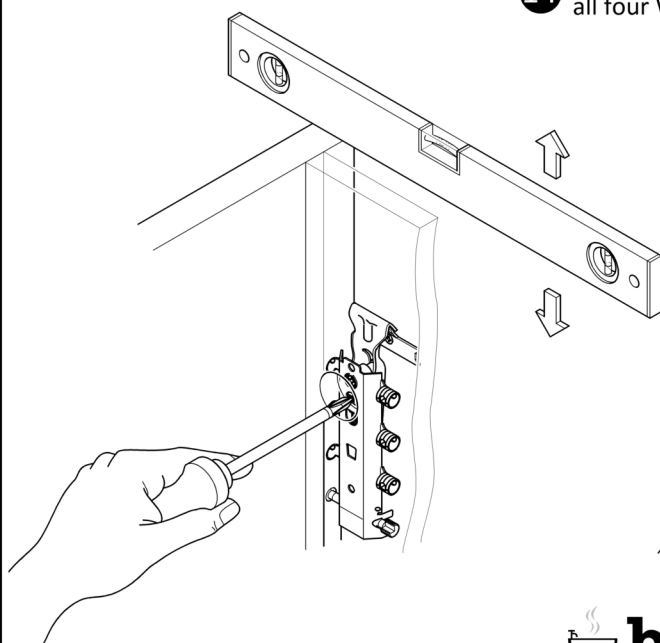

- 15** Insert Hole caps

Hanging Bracket  
Cover Cap x4

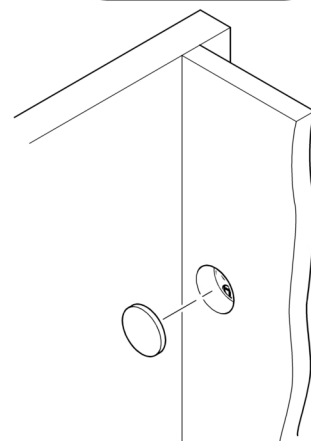

- 16** Insert Metal Shelf Pegs x8  
to support the  
Adjustable Shelves x2



- 17** Attach the Doors  
to the Hinge Hangers

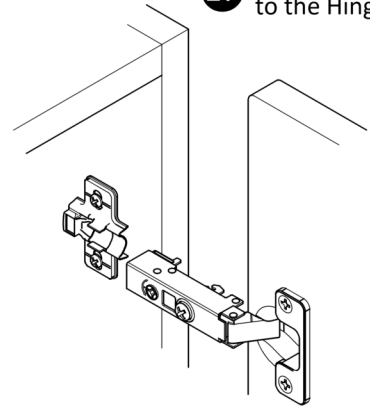

- 18** Adjust the Hinges until  
the Door sits correctly

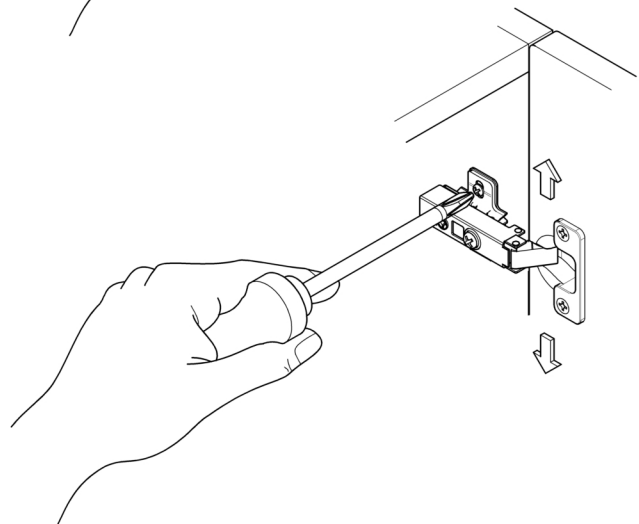
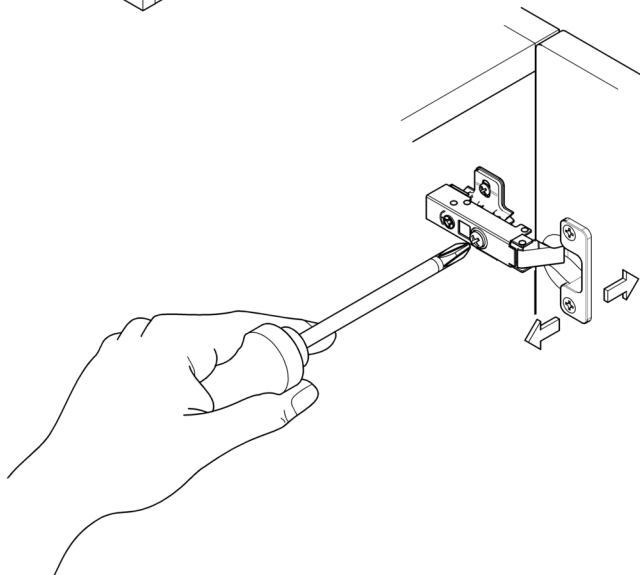
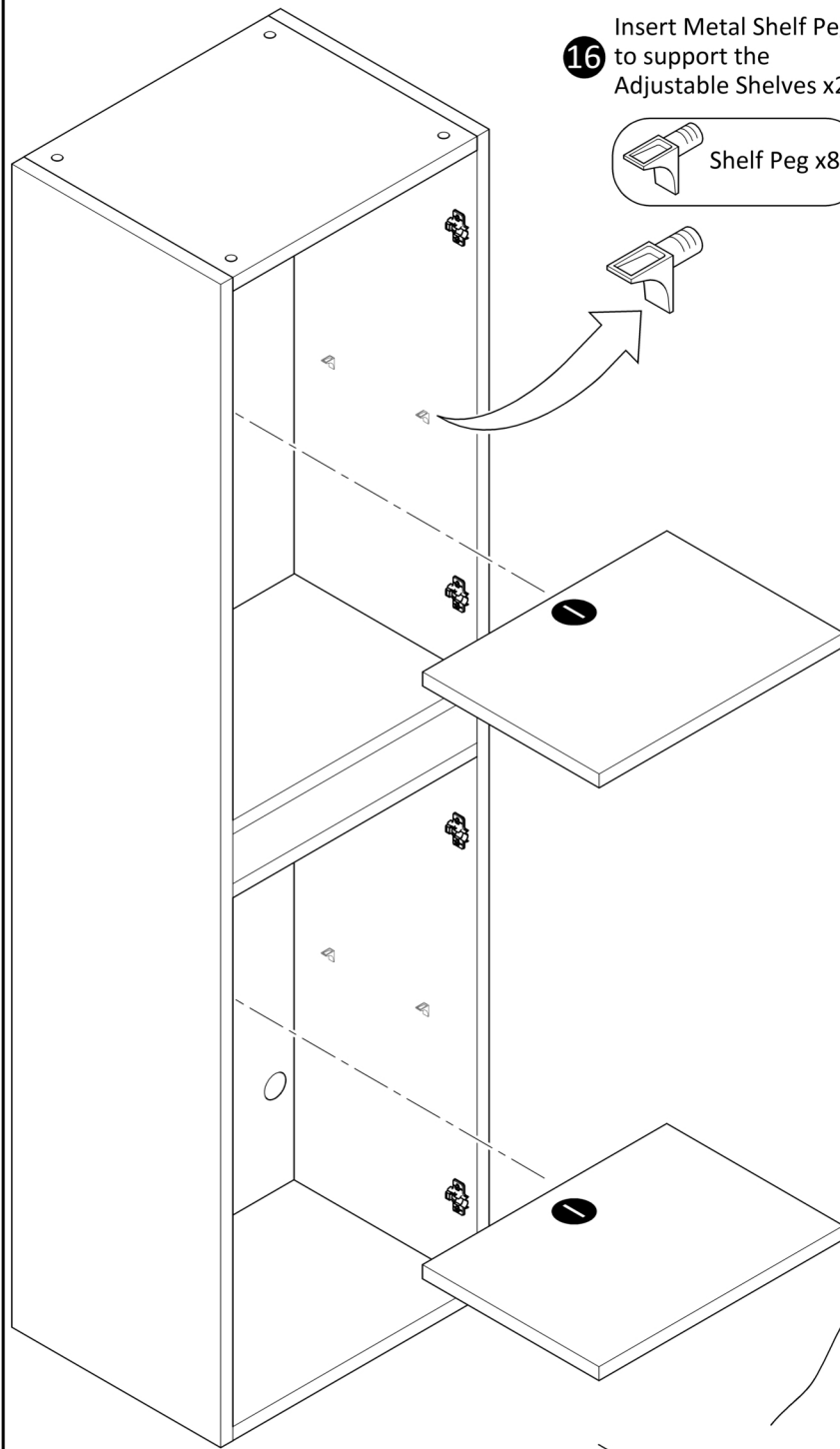
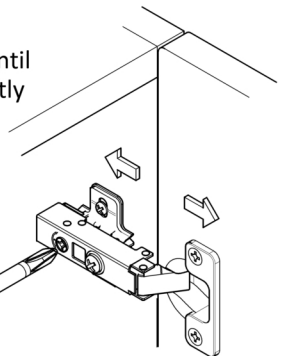

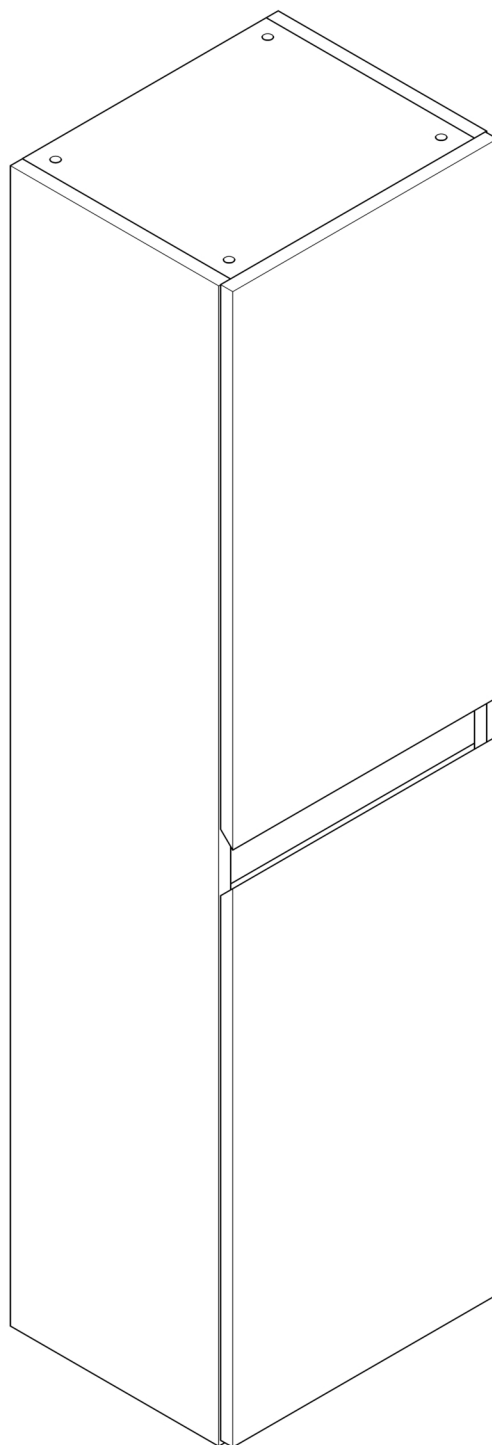

### **Care and Maintenance**

#### **Please Leave with the householder**

This furniture is made of wood, and has a water resistant finish. It should not be left wet. The quality of the finish is best maintained if it is wiped with a dry cloth after use. It should only be cleaned using a soft damp cloth followed by a dry cloth. Do not use bleach or any abrasive cleaner.

For more information visit [www.bathstore.com](http://www.bathstore.com)